

RECORDING REQUESTED BY:
(Mail Recording to:)

Charles Watson
Advanced Geologic Exploration, Inc.
PO Box 1956
Chester, CA 96020

Placer Mining Claim Certificate of Location

1. The name of this Placer Mining Claim is: **LVW 1**
2. The date of this location as posted on said claim is: _____
3. The discovery monument is described as a wooden post painted red and secured in a mound of stone with an attached plastic bottle that contains the location notice.
4. The general course of the placer deposit is north to south.
5. The Placer Mining Claim is in **Esmeralda County**, Nevada and contains **±20 acres**.
6. The U.S. Public Land Survey and the legal subdivision including Aliquot Part Description is:

**W1/2 SE1/4 NW1/4 of Section, 3
Township 6S, Range 41E, M.D.M.**

7. Claim Location Map:

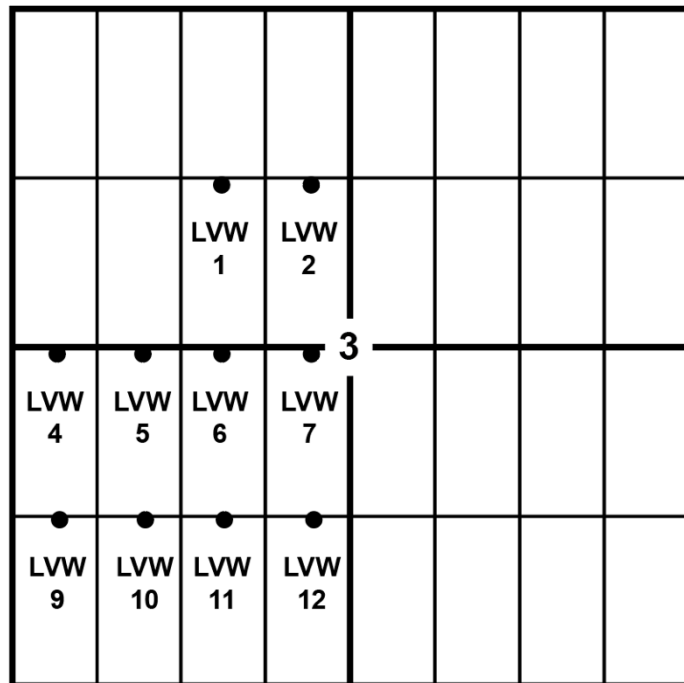

8. Locators of this Placer Claim:

Charles Watson
Advanced Geologic Exploration, Inc.
PO Box 1956
Chester, CA 96020

9. Signed by Charles P. Watson, Advanced Geologic _____.

RECORDING REQUESTED BY:
(Mail Recording to:)

Charles Watson
Advanced Geologic Exploration, Inc.
PO Box 1956
Chester, CA 96020

Placer Mining Claim Certificate of Location

1. The name of this Placer Mining Claim is: **LVW 2**
2. The date of this location as posted on said claim is: _____
3. The discovery monument is described as a wooden post painted red and secured in a mound of stone with an attached plastic bottle that contains the location notice.
4. The general course of the placer deposit is north to south.
5. The Placer Mining Claim is in **Esmeralda County**, Nevada and contains **±20 acres**.
6. The U.S. Public Land Survey and the legal subdivision including Aliquot Part Description is:

**E1/2 SE1/4 NW1/4 of Section, 3
Township 6S, Range 41E, M.D.M.**

7. Claim Location Map:

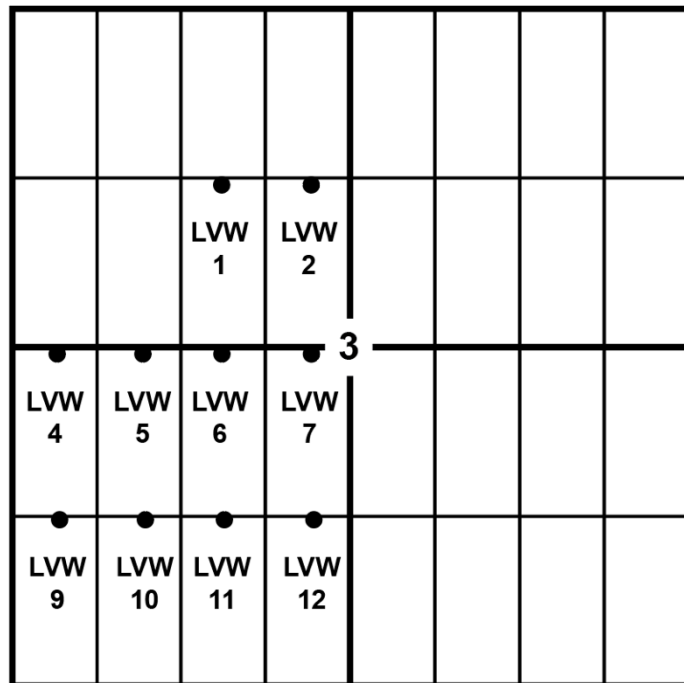

8. Locators of this Placer Claim:

Charles Watson
Advanced Geologic Exploration, Inc.
PO Box 1956
Chester, CA 96020

9. Signed by Charles P. Watson, Advanced Geologic _____.

RECORDING REQUESTED BY:
(Mail Recording to:)

Charles Watson
Advanced Geologic Exploration, Inc.
PO Box 1956
Chester, CA 96020

Placer Mining Claim Certificate of Location

1. The name of this Placer Mining Claim is: **LVW 3**
2. The date of this location as posted on said claim is: _____
3. The discovery monument is described as a wooden post painted red and secured in a mound of stone with an attached plastic bottle that contains the location notice.
4. The general course of the placer deposit is north to south.
5. The Placer Mining Claim is in **Esmeralda County**, Nevada and contains **±20 acres**.
6. The U.S. Public Land Survey and the legal subdivision including Aliquot Part Description is:

**E1/2 NE1/4 SE1/4 of Section, 4
Township 6S, Range 41E, M.D.M.**

7. Claim Location Map:

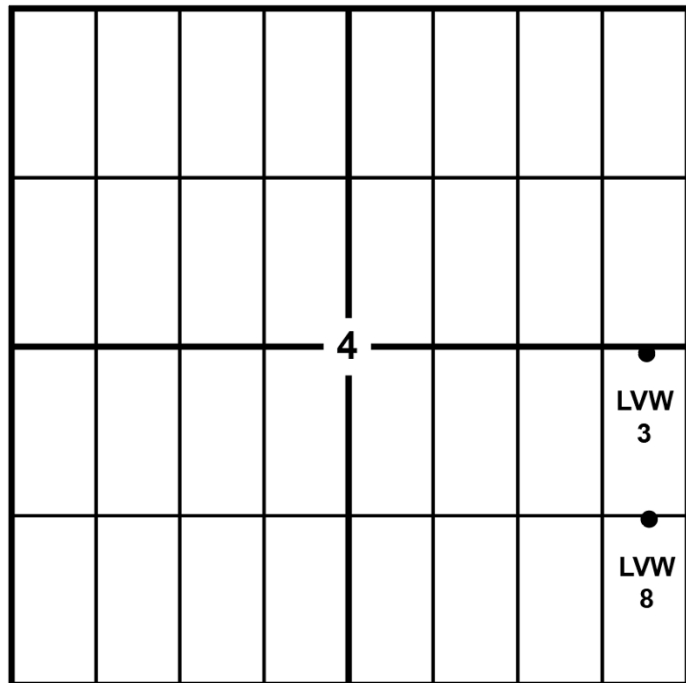

8. Locators of this Placer Claim:

Charles Watson
Advanced Geologic Exploration, Inc.
PO Box 1956
Chester, CA 96020

9. Signed by Charles P. Watson, Advanced Geologic _____.

RECORDING REQUESTED BY:
(Mail Recording to:)

Charles Watson
Advanced Geologic Exploration, Inc.
PO Box 1956
Chester, CA 96020

Placer Mining Claim Certificate of Location

1. The name of this Placer Mining Claim is: **LVW 4**
2. The date of this location as posted on said claim is: _____
3. The discovery monument is described as a wooden post painted red and secured in a mound of stone with an attached plastic bottle that contains the location notice.
4. The general course of the placer deposit is north to south.
5. The Placer Mining Claim is in **Esmeralda County**, Nevada and contains **±20 acres**.
6. The U.S. Public Land Survey and the legal subdivision including Aliquot Part Description is:

**W1/2 NW1/4 SW1/4 of Section, 3
Township 6S, Range 41E, M.D.M.**

7. Claim Location Map:

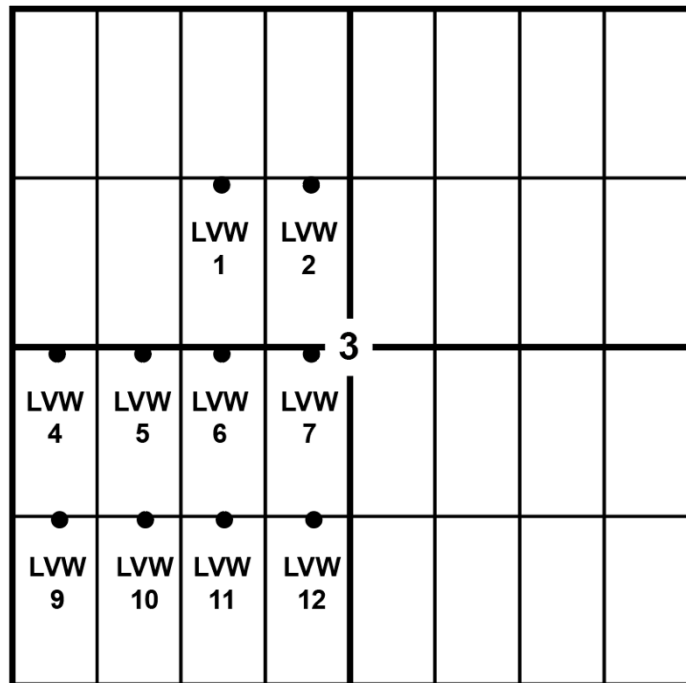

8. Locators of this Placer Claim:

Charles Watson
Advanced Geologic Exploration, Inc.
PO Box 1956
Chester, CA 96020

9. Signed by Charles P. Watson, Advanced Geologic _____.

RECORDING REQUESTED BY:
(Mail Recording to:)

Charles Watson
Advanced Geologic Exploration, Inc.
PO Box 1956
Chester, CA 96020

Placer Mining Claim Certificate of Location

1. The name of this Placer Mining Claim is: **LVW 5**
2. The date of this location as posted on said claim is: _____
3. The discovery monument is described as a wooden post painted red and secured in a mound of stone with an attached plastic bottle that contains the location notice.
4. The general course of the placer deposit is north to south.
5. The Placer Mining Claim is in **Esmeralda County**, Nevada and contains **±20 acres**.
6. The U.S. Public Land Survey and the legal subdivision including Aliquot Part Description is:

**E1/2 NW1/4 SW1/4 of Section, 3
Township 6S, Range 41E, M.D.M.**

7. Claim Location Map:

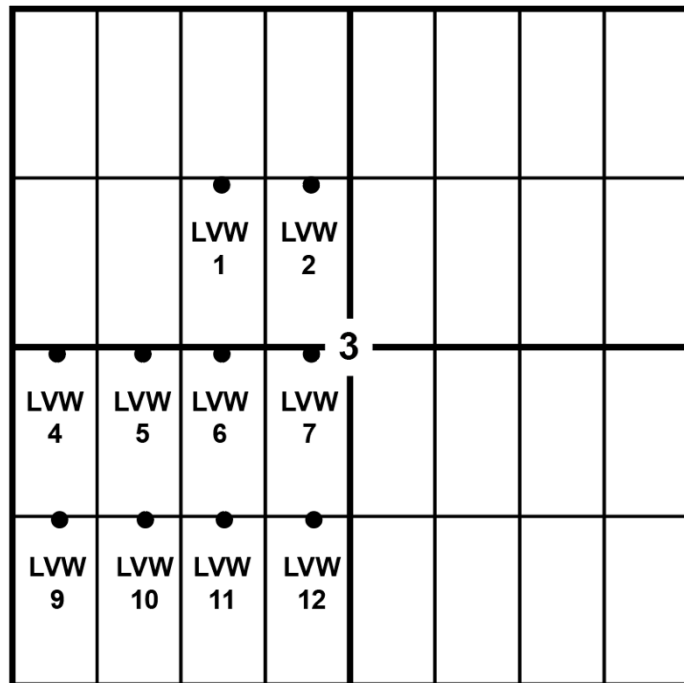

8. Locators of this Placer Claim:

Charles Watson
Advanced Geologic Exploration, Inc.
PO Box 1956
Chester, CA 96020

9. Signed by Charles P. Watson, Advanced Geologic _____.

RECORDING REQUESTED BY:
(Mail Recording to:)

Charles Watson
Advanced Geologic Exploration, Inc.
PO Box 1956
Chester, CA 96020

Placer Mining Claim Certificate of Location

1. The name of this Placer Mining Claim is: **LVW 6**
2. The date of this location as posted on said claim is: _____
3. The discovery monument is described as a wooden post painted red and secured in a mound of stone with an attached plastic bottle that contains the location notice.
4. The general course of the placer deposit is north to south.
5. The Placer Mining Claim is in **Esmeralda County**, Nevada and contains **±20 acres**.
6. The U.S. Public Land Survey and the legal subdivision including Aliquot Part Description is:

**W1/2 NE1/4 SW1/4 of Section, 3
Township 6S, Range 41E, M.D.M.**

7. Claim Location Map:

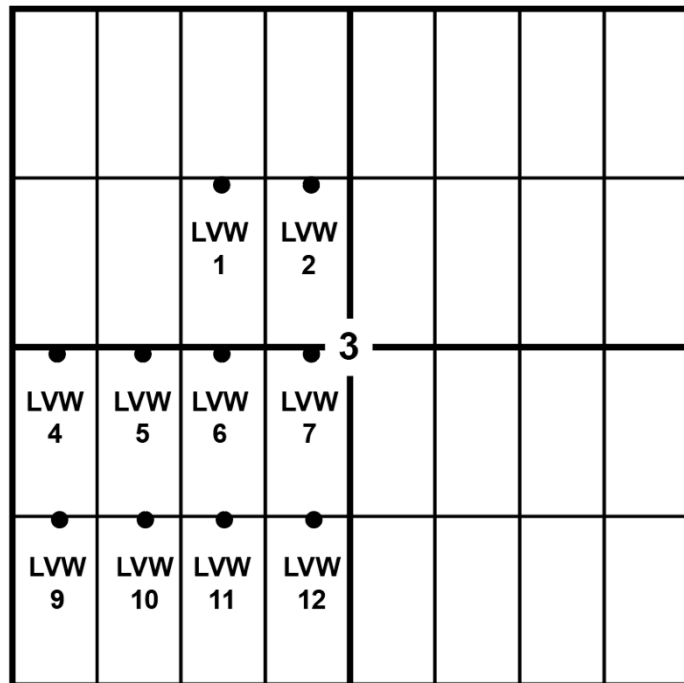

8. Locators of this Placer Claim:

Charles Watson
Advanced Geologic Exploration, Inc.
PO Box 1956
Chester, CA 96020

9. Signed by Charles P. Watson, Advanced Geologic _____.

RECORDING REQUESTED BY:
(Mail Recording to:)

Charles Watson
Advanced Geologic Exploration, Inc.
PO Box 1956
Chester, CA 96020

Placer Mining Claim Certificate of Location

1. The name of this Placer Mining Claim is: **LVW 7**
2. The date of this location as posted on said claim is: _____
3. The discovery monument is described as a wooden post painted red and secured in a mound of stone with an attached plastic bottle that contains the location notice.
4. The general course of the placer deposit is north to south.
5. The Placer Mining Claim is in **Esmeralda County**, Nevada and contains **±20 acres**.
6. The U.S. Public Land Survey and the legal subdivision including Aliquot Part Description is:

**E1/2 NE1/4 SW1/4 of Section, 3
Township 6S, Range 41E, M.D.M.**

7. Claim Location Map:

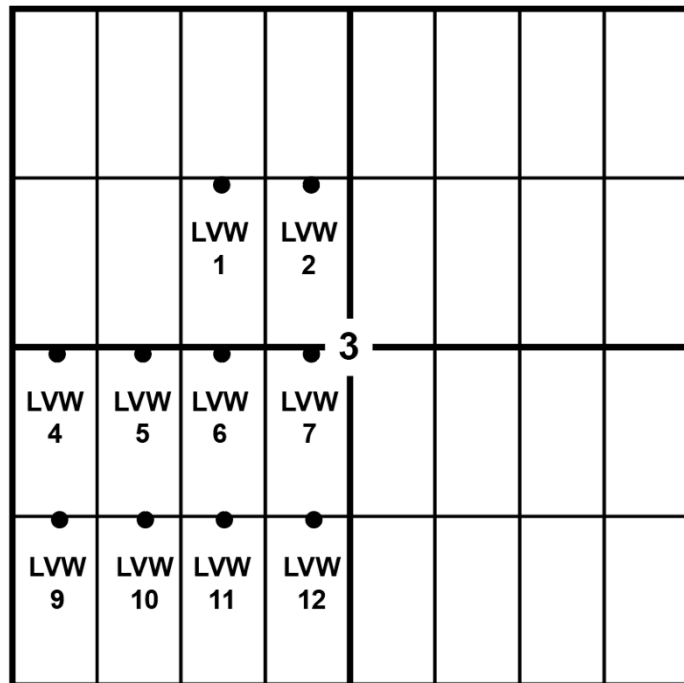

8. Locators of this Placer Claim:

Charles Watson
Advanced Geologic Exploration, Inc.
PO Box 1956
Chester, CA 96020

9. Signed by Charles P. Watson, Advanced Geologic _____.

RECORDING REQUESTED BY:
(Mail Recording to:)

Charles Watson
Advanced Geologic Exploration, Inc.
PO Box 1956
Chester, CA 96020

Placer Mining Claim Certificate of Location

1. The name of this Placer Mining Claim is: **LVW 8**
2. The date of this location as posted on said claim is: _____
3. The discovery monument is described as a wooden post painted red and secured in a mound of stone with an attached plastic bottle that contains the location notice.
4. The general course of the placer deposit is north to south.
5. The Placer Mining Claim is in **Esmeralda County**, Nevada and contains **±20 acres**.
6. The U.S. Public Land Survey and the legal subdivision including Aliquot Part Description is:

**E1/2 SE1/4 SE1/4 of Section, 4
Township 6S, Range 41E, M.D.M.**

7. Claim Location Map:

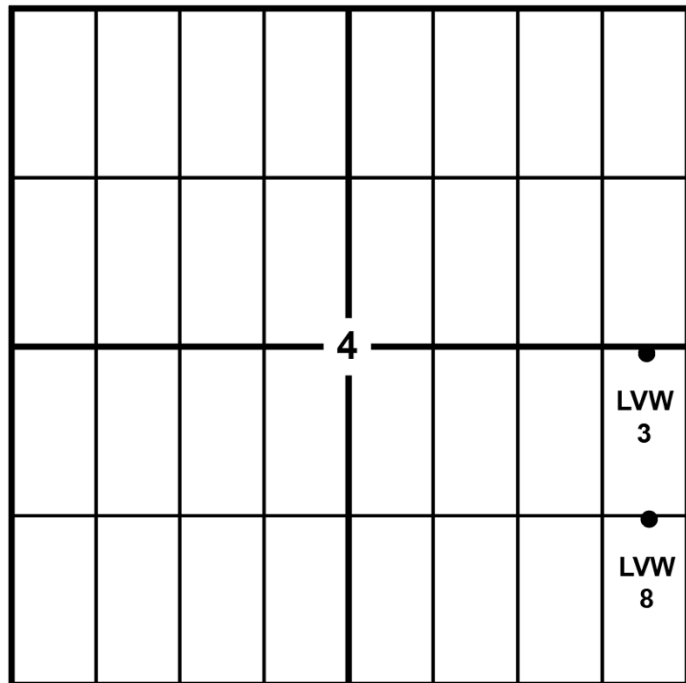

8. Locators of this Placer Claim:

Charles Watson
Advanced Geologic Exploration, Inc.
PO Box 1956
Chester, CA 96020

9. Signed by Charles P. Watson, Advanced Geologic _____.

RECORDING REQUESTED BY:
(Mail Recording to:)

Charles Watson
Advanced Geologic Exploration, Inc.
PO Box 1956
Chester, CA 96020

Placer Mining Claim Certificate of Location

1. The name of this Placer Mining Claim is: **LVW 9**
2. The date of this location as posted on said claim is: _____
3. The discovery monument is described as a wooden post painted red and secured in a mound of stone with an attached plastic bottle that contains the location notice.
4. The general course of the placer deposit is north to south.
5. The Placer Mining Claim is in **Esmeralda County**, Nevada and contains **±20 acres**.
6. The U.S. Public Land Survey and the legal subdivision including Aliquot Part Description is:

**W1/2 SW1/4 SW1/4 of Section, 3
Township 6S, Range 41E, M.D.M.**

7. Claim Location Map:

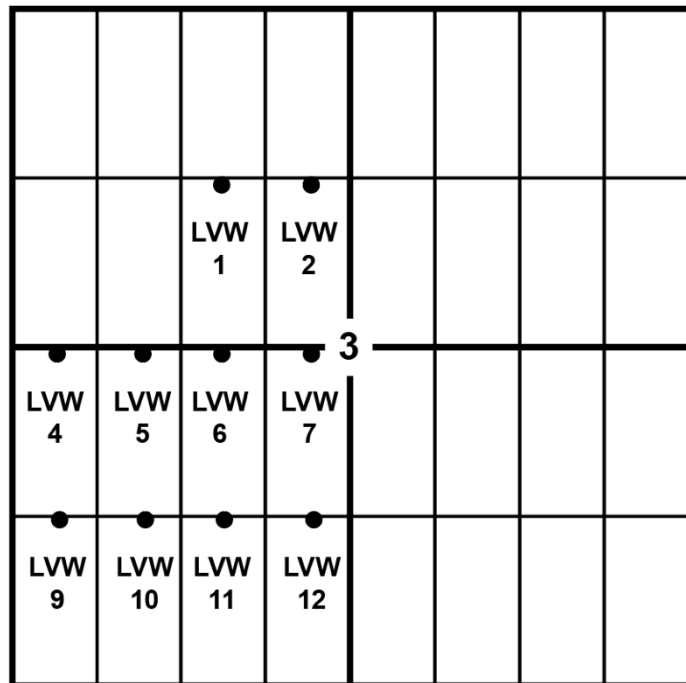

8. Locators of this Placer Claim:

Charles Watson
Advanced Geologic Exploration, Inc.
PO Box 1956
Chester, CA 96020

9. Signed by Charles P. Watson, Advanced Geologic _____.

RECORDING REQUESTED BY:
(Mail Recording to:)

Charles Watson
Advanced Geologic Exploration, Inc.
PO Box 1956
Chester, CA 96020

Placer Mining Claim Certificate of Location

1. The name of this Placer Mining Claim is: **LVW 10**
2. The date of this location as posted on said claim is: _____
3. The discovery monument is described as a wooden post painted red and secured in a mound of stone with an attached plastic bottle that contains the location notice.
4. The general course of the placer deposit is north to south.
5. The Placer Mining Claim is in **Esmeralda County**, Nevada and contains **±20 acres**.
6. The U.S. Public Land Survey and the legal subdivision including Aliquot Part Description is:

**E1/2 SW1/4 SW1/4 of Section, 3
Township 6S, Range 41E, M.D.M.**

7. Claim Location Map:

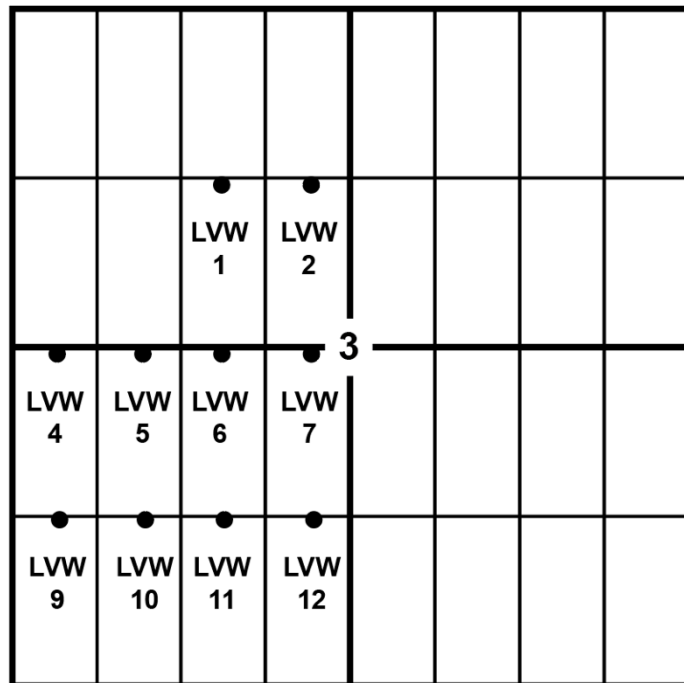

8. Locators of this Placer Claim:

Charles Watson
Advanced Geologic Exploration, Inc.
PO Box 1956
Chester, CA 96020

9. Signed by Charles P. Watson, Advanced Geologic _____.

RECORDING REQUESTED BY:
(Mail Recording to:)

Charles Watson
Advanced Geologic Exploration, Inc.
PO Box 1956
Chester, CA 96020

Placer Mining Claim Certificate of Location

1. The name of this Placer Mining Claim is: **LVW 11**
2. The date of this location as posted on said claim is: _____
3. The discovery monument is described as a wooden post painted red and secured in a mound of stone with an attached plastic bottle that contains the location notice.
4. The general course of the placer deposit is north to south.
5. The Placer Mining Claim is in **Esmeralda County**, Nevada and contains **±20 acres**.
6. The U.S. Public Land Survey and the legal subdivision including Aliquot Part Description is:

**W1/2 SE1/4 SW1/4 of Section, 3
Township 6S, Range 41E, M.D.M.**

7. Claim Location Map:

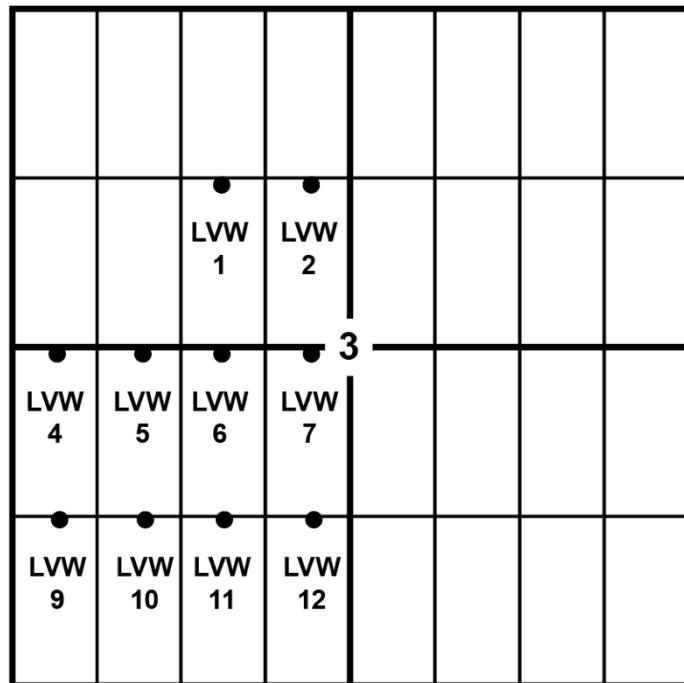

8. Locators of this Placer Claim:

Charles Watson
Advanced Geologic Exploration, Inc.
PO Box 1956
Chester, CA 96020

9. Signed by Charles P. Watson, Advanced Geologic _____.

RECORDING REQUESTED BY:
(Mail Recording to:)

Charles Watson
Advanced Geologic Exploration, Inc.
PO Box 1956
Chester, CA 96020

Placer Mining Claim Certificate of Location

1. The name of this Placer Mining Claim is: **LVW 12**
2. The date of this location as posted on said claim is: _____
3. The discovery monument is described as a wooden post painted red and secured in a mound of stone with an attached plastic bottle that contains the location notice.
4. The general course of the placer deposit is north to south.
5. The Placer Mining Claim is in **Esmeralda County**, Nevada and contains **±20 acres**.
6. The U.S. Public Land Survey and the legal subdivision including Aliquot Part Description is:

**E1/2 SE1/4 SW1/4 of Section, 3
Township 6S, Range 41E, M.D.M.**

7. Claim Location Map:

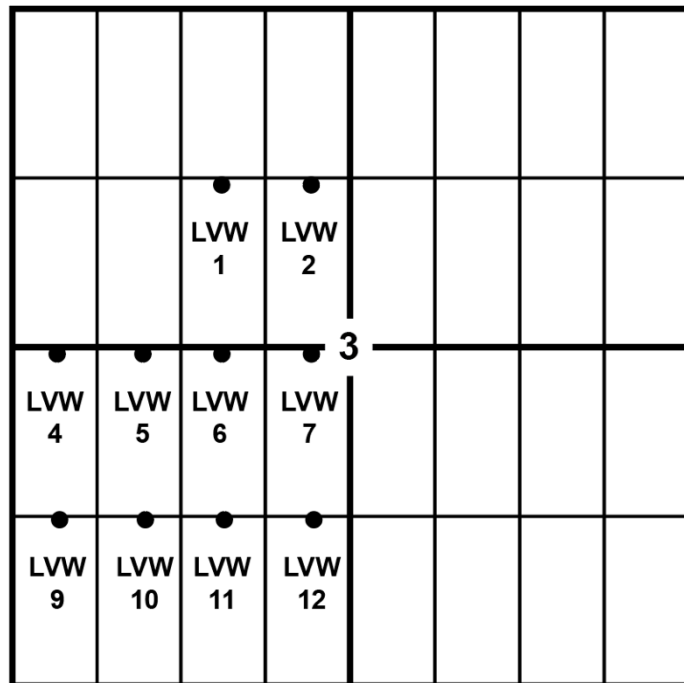

8. Locators of this Placer Claim:

Charles Watson
Advanced Geologic Exploration, Inc.
PO Box 1956
Chester, CA 96020

9. Signed by Charles P. Watson, Advanced Geologic _____.

RECORDING REQUESTED BY:
(Mail Recording to:)

Charles Watson
Advanced Geologic Exploration, Inc.
PO Box 1956
Chester, CA 96020

Placer Mining Claim Certificate of Location

1. The name of this Placer Mining Claim is: **LVW 13**
2. The date of this location as posted on said claim is: _____
3. The discovery monument is described as a wooden post painted red and secured in a mound of stone with an attached plastic bottle that contains the location notice.
4. The general course of the placer deposit is north to south.
5. The Placer Mining Claim is in **Esmeralda County**, Nevada and contains **±20 acres**.
6. The U.S. Public Land Survey and the legal subdivision including Aliquot Part Description is:

**W1/2 NW1/4 NE1/4 of Section, 9
Township 6S, Range 41E, M.D.M.**

7. Claim Location Map:

| | | | | | | | |
|--|--|--|---|----------------|----------------|----------------|----------------|
| | | | | ● LVW 13 | ● LVW 14 | ● LVW 15 | ● LVW 16 |
| | | | | ● LVW 21 | ● LVW 22 | ● LVW 23 | ● LVW 24 |
| | | | 9 | ● LVW 28 | ● LVW 29 | ● LVW 30 | ● LVW 31 |
| | | | | ● LVW 34 | ● LVW 35 | ● LVW 36 | ● LVW 37 |

8. Locators of this Placer Claim:

Charles Watson
Advanced Geologic Exploration, Inc.
PO Box 1956
Chester, CA 96020

9. Signed by Charles P. Watson, Advanced Geologic _____.

RECORDING REQUESTED BY:
(Mail Recording to:)

Charles Watson
Advanced Geologic Exploration, Inc.
PO Box 1956
Chester, CA 96020

Placer Mining Claim Certificate of Location

1. The name of this Placer Mining Claim is: **LVW 14**
2. The date of this location as posted on said claim is: _____
3. The discovery monument is described as a wooden post painted red and secured in a mound of stone with an attached plastic bottle that contains the location notice.
4. The general course of the placer deposit is north to south.
5. The Placer Mining Claim is in **Esmeralda County**, Nevada and contains **±20 acres**.
6. The U.S. Public Land Survey and the legal subdivision including Aliquot Part Description is:

**E1/2 NW1/4 NE1/4 of Section, 9
Township 6S, Range 41E, M.D.M.**

7. Claim Location Map:

| | | | | | | | |
|--|--|--|--|----------------|----------------|----------------|----------------|
| | | | | ● LVW 13 | ● LVW 14 | ● LVW 15 | ● LVW 16 |
| | | | | ● LVW 21 | ● LVW 22 | ● LVW 23 | ● LVW 24 |
| | | | | ● LVW 28 | ● LVW 29 | ● LVW 30 | ● LVW 31 |
| | | | | ● LVW 34 | ● LVW 35 | ● LVW 36 | ● LVW 37 |

9

8. Locators of this Placer Claim:

Charles Watson
Advanced Geologic Exploration, Inc.
PO Box 1956
Chester, CA 96020

9. Signed by Charles P. Watson, Advanced Geologic _____.

RECORDING REQUESTED BY:
(Mail Recording to:)

Charles Watson
Advanced Geologic Exploration, Inc.
PO Box 1956
Chester, CA 96020

Placer Mining Claim Certificate of Location

1. The name of this Placer Mining Claim is: **LVW 15**
2. The date of this location as posted on said claim is: _____
3. The discovery monument is described as a wooden post painted red and secured in a mound of stone with an attached plastic bottle that contains the location notice.
4. The general course of the placer deposit is north to south.
5. The Placer Mining Claim is in **Esmeralda County**, Nevada and contains **±20 acres**.
6. The U.S. Public Land Survey and the legal subdivision including Aliquot Part Description is:

**W1/2 NE1/4 NE1/4 of Section, 9
Township 6S, Range 41E, M.D.M.**

7. Claim Location Map:

| | | | | | | | |
|--|--|--|--|----------------|----------------|----------------|----------------|
| | | | | ● LVW 13 | ● LVW 14 | ● LVW 15 | ● LVW 16 |
| | | | | ● LVW 21 | ● LVW 22 | ● LVW 23 | ● LVW 24 |
| | | | | ● LVW 28 | ● LVW 29 | ● LVW 30 | ● LVW 31 |
| | | | | ● LVW 34 | ● LVW 35 | ● LVW 36 | ● LVW 37 |

9

8. Locators of this Placer Claim:

Charles Watson
Advanced Geologic Exploration, Inc.
PO Box 1956
Chester, CA 96020

9. Signed by Charles P. Watson, Advanced Geologic _____.

RECORDING REQUESTED BY:
(Mail Recording to:)

Charles Watson
Advanced Geologic Exploration, Inc.
PO Box 1956
Chester, CA 96020

Placer Mining Claim Certificate of Location

1. The name of this Placer Mining Claim is: **LVW 16**
2. The date of this location as posted on said claim is: _____
3. The discovery monument is described as a wooden post painted red and secured in a mound of stone with an attached plastic bottle that contains the location notice.
4. The general course of the placer deposit is north to south.
5. The Placer Mining Claim is in **Esmeralda County**, Nevada and contains **±20 acres**.
6. The U.S. Public Land Survey and the legal subdivision including Aliquot Part Description is:

**E1/2 NE1/4 NE1/4 of Section, 9
Township 6S, Range 41E, M.D.M.**

7. Claim Location Map:

| | | | | | | | |
|--|--|--|--|----------------|----------------|----------------|----------------|
| | | | | ● LVW 13 | ● LVW 14 | ● LVW 15 | ● LVW 16 |
| | | | | ● LVW 21 | ● LVW 22 | ● LVW 23 | ● LVW 24 |
| | | | | ● LVW 28 | ● LVW 29 | ● LVW 30 | ● LVW 31 |
| | | | | ● LVW 34 | ● LVW 35 | ● LVW 36 | ● LVW 37 |

9

8. Locators of this Placer Claim:

Charles Watson
Advanced Geologic Exploration, Inc.
PO Box 1956
Chester, CA 96020

9. Signed by Charles P. Watson, Advanced Geologic _____.

RECORDING REQUESTED BY:
(Mail Recording to:)

Charles Watson
Advanced Geologic Exploration, Inc.
PO Box 1956
Chester, CA 96020

Placer Mining Claim Certificate of Location

1. The name of this Placer Mining Claim is: **LVW 17**
2. The date of this location as posted on said claim is: _____
3. The discovery monument is described as a wooden post painted red and secured in a mound of stone with an attached plastic bottle that contains the location notice.
4. The general course of the placer deposit is north to south.
5. The Placer Mining Claim is in **Esmeralda County**, Nevada and contains **±20 acres**.
6. The U.S. Public Land Survey and the legal subdivision including Aliquot Part Description is:

**W1/2 NW1/4 NW1/4 of Section, 10
Township 6S, Range 41E, M.D.M.**

7. Claim Location Map:

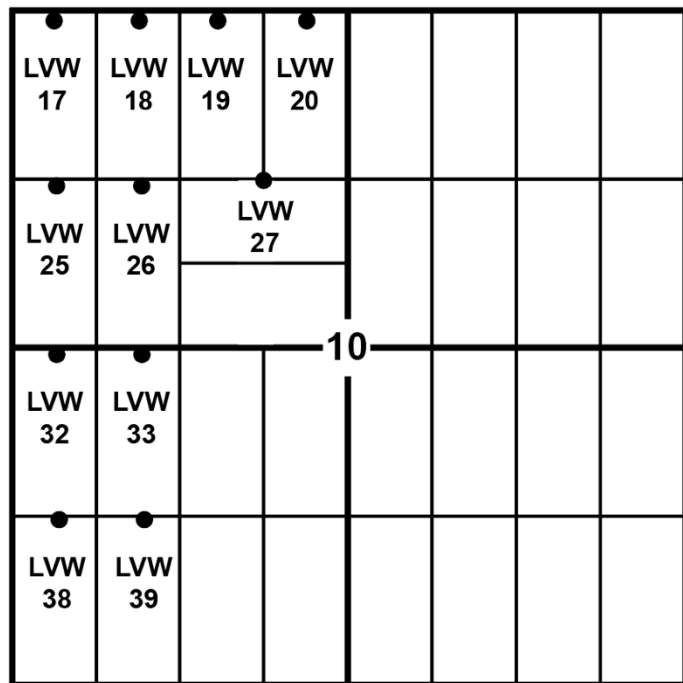

8. Locators of this Placer Claim:

Charles Watson
Advanced Geologic Exploration, Inc.
PO Box 1956
Chester, CA 96020

9. Signed by Charles P. Watson, Advanced Geologic _____.

RECORDING REQUESTED BY:
(Mail Recording to:)

Charles Watson
Advanced Geologic Exploration, Inc.
PO Box 1956
Chester, CA 96020

Placer Mining Claim Certificate of Location

1. The name of this Placer Mining Claim is: **LVW 18**
2. The date of this location as posted on said claim is: _____
3. The discovery monument is described as a wooden post painted red and secured in a mound of stone with an attached plastic bottle that contains the location notice.
4. The general course of the placer deposit is north to south.
5. The Placer Mining Claim is in **Esmeralda County**, Nevada and contains **±20 acres**.
6. The U.S. Public Land Survey and the legal subdivision including Aliquot Part Description is:

**E1/2 NW1/4 NW1/4 of Section, 10
Township 6S, Range 41E, M.D.M.**

7. Claim Location Map:

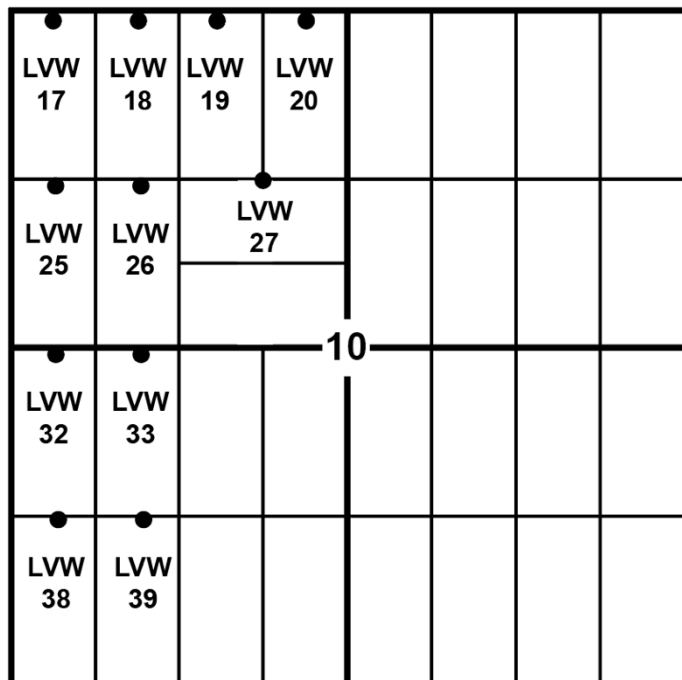

8. Locators of this Placer Claim:

Charles Watson
Advanced Geologic Exploration, Inc.
PO Box 1956
Chester, CA 96020

9. Signed by Charles P. Watson, Advanced Geologic _____.

RECORDING REQUESTED BY:
(Mail Recording to:)

Charles Watson
Advanced Geologic Exploration, Inc.
PO Box 1956
Chester, CA 96020

Placer Mining Claim Certificate of Location

1. The name of this Placer Mining Claim is: **LVW 19**
2. The date of this location as posted on said claim is: _____
3. The discovery monument is described as a wooden post painted red and secured in a mound of stone with an attached plastic bottle that contains the location notice.
4. The general course of the placer deposit is north to south.
5. The Placer Mining Claim is in **Esmeralda County**, Nevada and contains **±20 acres**.
6. The U.S. Public Land Survey and the legal subdivision including Aliquot Part Description is:

**W1/2 NE1/4 NW1/4 of Section, 10
Township 6S, Range 41E, M.D.M.**

7. Claim Location Map:

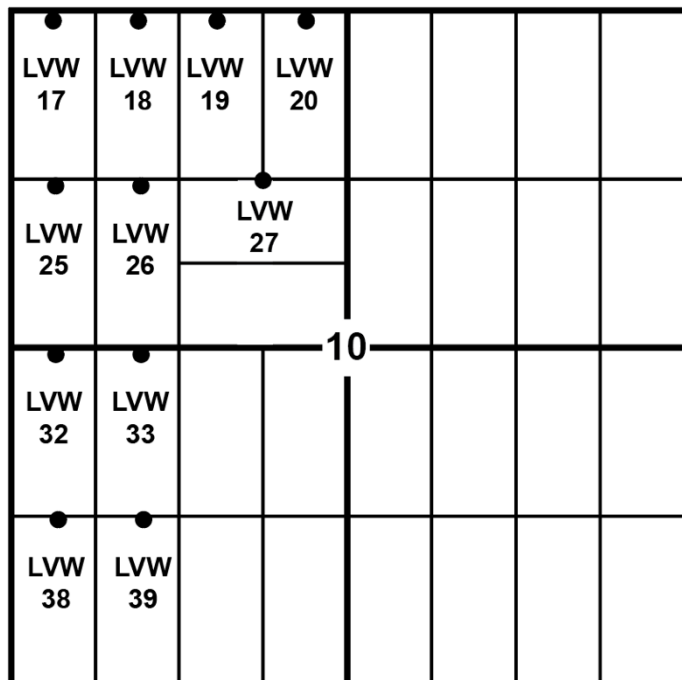

8. Locators of this Placer Claim:

Charles Watson
Advanced Geologic Exploration, Inc.
PO Box 1956
Chester, CA 96020

9. Signed by Charles P. Watson, Advanced Geologic _____.

RECORDING REQUESTED BY:
(Mail Recording to:)

Charles Watson
Advanced Geologic Exploration, Inc.
PO Box 1956
Chester, CA 96020

Placer Mining Claim Certificate of Location

1. The name of this Placer Mining Claim is: **LVW 20**
2. The date of this location as posted on said claim is: _____
3. The discovery monument is described as a wooden post painted red and secured in a mound of stone with an attached plastic bottle that contains the location notice.
4. The general course of the placer deposit is north to south.
5. The Placer Mining Claim is in **Esmeralda County**, Nevada and contains **±20 acres**.
6. The U.S. Public Land Survey and the legal subdivision including Aliquot Part Description is:

**E1/2 NE1/4 NW1/4 of Section, 10
Township 6S, Range 41E, M.D.M.**

7. Claim Location Map:

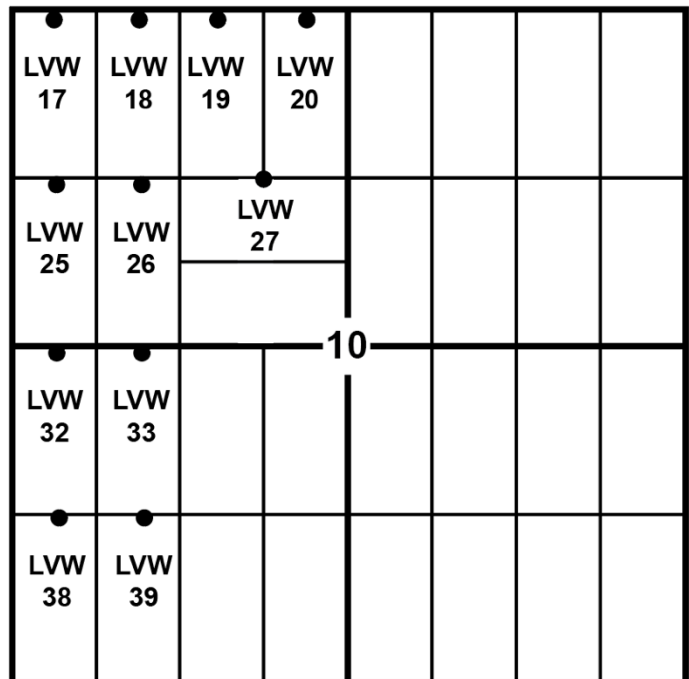

8. Locators of this Placer Claim:

Charles Watson
Advanced Geologic Exploration, Inc.
PO Box 1956
Chester, CA 96020

9. Signed by Charles P. Watson, Advanced Geologic _____.

RECORDING REQUESTED BY:
(Mail Recording to:)

Charles Watson
Advanced Geologic Exploration, Inc.
PO Box 1956
Chester, CA 96020

Placer Mining Claim Certificate of Location

1. The name of this Placer Mining Claim is: **LVW 21**
2. The date of this location as posted on said claim is: _____
3. The discovery monument is described as a wooden post painted red and secured in a mound of stone with an attached plastic bottle that contains the location notice.
4. The general course of the placer deposit is north to south.
5. The Placer Mining Claim is in **Esmeralda County**, Nevada and contains **±20 acres**.
6. The U.S. Public Land Survey and the legal subdivision including Aliquot Part Description is:

**W1/2 SW1/4 NE1/4 of Section, 9
Township 6S, Range 41E, M.D.M.**

7. Claim Location Map:

| | | | | | | | |
|--|--|--|--|----------------|----------------|----------------|----------------|
| | | | | ● LVW 13 | ● LVW 14 | ● LVW 15 | ● LVW 16 |
| | | | | ● LVW 21 | ● LVW 22 | ● LVW 23 | ● LVW 24 |
| | | | | ● LVW 28 | ● LVW 29 | ● LVW 30 | ● LVW 31 |
| | | | | ● LVW 34 | ● LVW 35 | ● LVW 36 | ● LVW 37 |

9

8. Locators of this Placer Claim:

Charles Watson
Advanced Geologic Exploration, Inc.
PO Box 1956
Chester, CA 96020

9. Signed by Charles P. Watson, Advanced Geologic _____.

RECORDING REQUESTED BY:
(Mail Recording to:)

Charles Watson
Advanced Geologic Exploration, Inc.
PO Box 1956
Chester, CA 96020

Placer Mining Claim Certificate of Location

1. The name of this Placer Mining Claim is: **LVW 22**
2. The date of this location as posted on said claim is: _____
3. The discovery monument is described as a wooden post painted red and secured in a mound of stone with an attached plastic bottle that contains the location notice.
4. The general course of the placer deposit is north to south.
5. The Placer Mining Claim is in **Esmeralda County**, Nevada and contains **±20 acres**.
6. The U.S. Public Land Survey and the legal subdivision including Aliquot Part Description is:

**E1/2 SW1/4 NE1/4 of Section, 9
Township 6S, Range 41E, M.D.M.**

7. Claim Location Map:

| | | | | | | | |
|--|--|--|--|----------------|----------------|----------------|----------------|
| | | | | ● LVW 13 | ● LVW 14 | ● LVW 15 | ● LVW 16 |
| | | | | ● LVW 21 | ● LVW 22 | ● LVW 23 | ● LVW 24 |
| | | | | ● LVW 28 | ● LVW 29 | ● LVW 30 | ● LVW 31 |
| | | | | ● LVW 34 | ● LVW 35 | ● LVW 36 | ● LVW 37 |

9

8. Locators of this Placer Claim:

Charles Watson
Advanced Geologic Exploration, Inc.
PO Box 1956
Chester, CA 96020

9. Signed by Charles P. Watson, Advanced Geologic _____.

RECORDING REQUESTED BY:
(Mail Recording to:)

Charles Watson
Advanced Geologic Exploration, Inc.
PO Box 1956
Chester, CA 96020

Placer Mining Claim Certificate of Location

1. The name of this Placer Mining Claim is: **LVW 23**
2. The date of this location as posted on said claim is: _____
3. The discovery monument is described as a wooden post painted red and secured in a mound of stone with an attached plastic bottle that contains the location notice.
4. The general course of the placer deposit is north to south.
5. The Placer Mining Claim is in **Esmeralda County**, Nevada and contains **±20 acres**.
6. The U.S. Public Land Survey and the legal subdivision including Aliquot Part Description is:

**W1/2 SE1/4 NE1/4 of Section, 9
Township 6S, Range 41E, M.D.M.**

7. Claim Location Map:

| | | | | | | | |
|--|--|--|--|----------------|----------------|----------------|----------------|
| | | | | ● LVW 13 | ● LVW 14 | ● LVW 15 | ● LVW 16 |
| | | | | ● LVW 21 | ● LVW 22 | ● LVW 23 | ● LVW 24 |
| | | | | ● LVW 28 | ● LVW 29 | ● LVW 30 | ● LVW 31 |
| | | | | ● LVW 34 | ● LVW 35 | ● LVW 36 | ● LVW 37 |

9

8. Locators of this Placer Claim:

Charles Watson
Advanced Geologic Exploration, Inc.
PO Box 1956
Chester, CA 96020

9. Signed by Charles P. Watson, Advanced Geologic _____.

RECORDING REQUESTED BY:
(Mail Recording to:)

Charles Watson
Advanced Geologic Exploration, Inc.
PO Box 1956
Chester, CA 96020

Placer Mining Claim Certificate of Location

1. The name of this Placer Mining Claim is: **LVW 24**
2. The date of this location as posted on said claim is: _____
3. The discovery monument is described as a wooden post painted red and secured in a mound of stone with an attached plastic bottle that contains the location notice.
4. The general course of the placer deposit is north to south.
5. The Placer Mining Claim is in **Esmeralda County**, Nevada and contains **±20 acres**.
6. The U.S. Public Land Survey and the legal subdivision including Aliquot Part Description is:

**E1/2 SE1/4 NE1/4 of Section, 9
Township 6S, Range 41E, M.D.M.**

7. Claim Location Map:

| | | | | | | | |
|--|--|--|--|----------------|----------------|----------------|----------------|
| | | | | ● LVW 13 | ● LVW 14 | ● LVW 15 | ● LVW 16 |
| | | | | ● LVW 21 | ● LVW 22 | ● LVW 23 | ● LVW 24 |
| | | | | ● LVW 28 | ● LVW 29 | ● LVW 30 | ● LVW 31 |
| | | | | ● LVW 34 | ● LVW 35 | ● LVW 36 | ● LVW 37 |

9

8. Locators of this Placer Claim:

Charles Watson
Advanced Geologic Exploration, Inc.
PO Box 1956
Chester, CA 96020

9. Signed by Charles P. Watson, Advanced Geologic _____.

RECORDING REQUESTED BY:
(Mail Recording to:)

Charles Watson
Advanced Geologic Exploration, Inc.
PO Box 1956
Chester, CA 96020

Placer Mining Claim Certificate of Location

1. The name of this Placer Mining Claim is: **LVW 25**
2. The date of this location as posted on said claim is: _____
3. The discovery monument is described as a wooden post painted red and secured in a mound of stone with an attached plastic bottle that contains the location notice.
4. The general course of the placer deposit is north to south.
5. The Placer Mining Claim is in **Esmeralda County**, Nevada and contains **±20 acres**.
6. The U.S. Public Land Survey and the legal subdivision including Aliquot Part Description is:

**W1/2 SW1/4 NW1/4 of Section, 10
Township 6S, Range 41E, M.D.M.**

7. Claim Location Map:

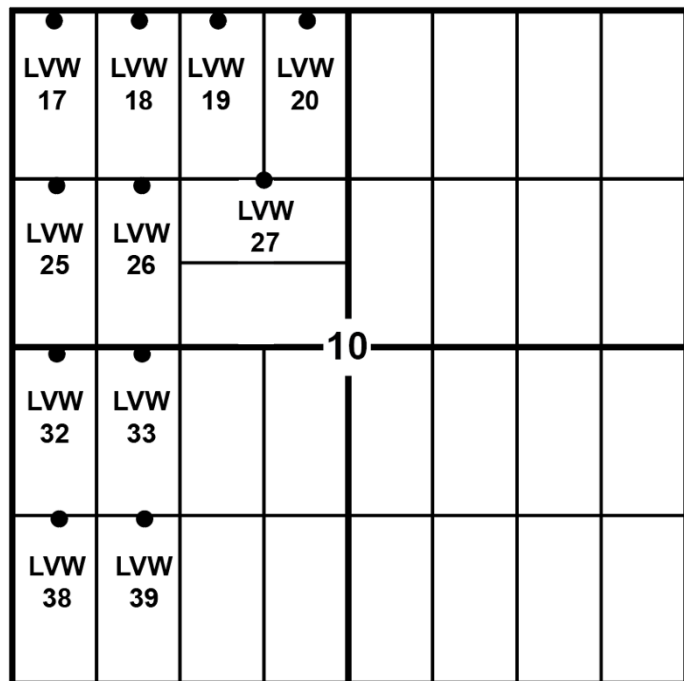

8. Locators of this Placer Claim:

Charles Watson
Advanced Geologic Exploration, Inc.
PO Box 1956
Chester, CA 96020

9. Signed by Charles P. Watson, Advanced Geologic _____.

RECORDING REQUESTED BY:
(Mail Recording to:)

Charles Watson
Advanced Geologic Exploration, Inc.
PO Box 1956
Chester, CA 96020

Placer Mining Claim Certificate of Location

1. The name of this Placer Mining Claim is: **LVW 26**
2. The date of this location as posted on said claim is: _____
3. The discovery monument is described as a wooden post painted red and secured in a mound of stone with an attached plastic bottle that contains the location notice.
4. The general course of the placer deposit is north to south.
5. The Placer Mining Claim is in **Esmeralda County**, Nevada and contains **±20 acres**.
6. The U.S. Public Land Survey and the legal subdivision including Aliquot Part Description is:

**E1/2 SW1/4 NW1/4 of Section, 10
Township 6S, Range 41E, M.D.M.**

7. Claim Location Map:

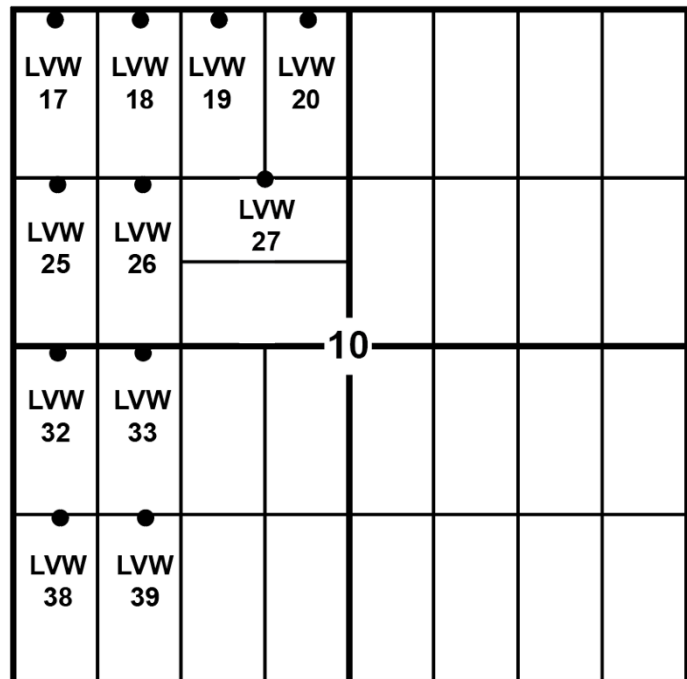

8. Locators of this Placer Claim:

Charles Watson
Advanced Geologic Exploration, Inc.
PO Box 1956
Chester, CA 96020

9. Signed by Charles P. Watson, Advanced Geologic _____.

RECORDING REQUESTED BY:
(Mail Recording to:)

Charles Watson
Advanced Geologic Exploration, Inc.
PO Box 1956
Chester, CA 96020

Placer Mining Claim Certificate of Location

1. The name of this Placer Mining Claim is: **LVW 27**
2. The date of this location as posted on said claim is: _____
3. The discovery monument is described as a wooden post painted red and secured in a mound of stone with an attached plastic bottle that contains the location notice.
4. The general course of the placer deposit is north to south.
5. The Placer Mining Claim is in **Esmeralda County**, Nevada and contains **±20 acres**.
6. The U.S. Public Land Survey and the legal subdivision including Aliquot Part Description is:

**N1/2 SE1/4 NW1/4 of Section, 10
Township 6S, Range 41E, M.D.M.**

7. Claim Location Map:

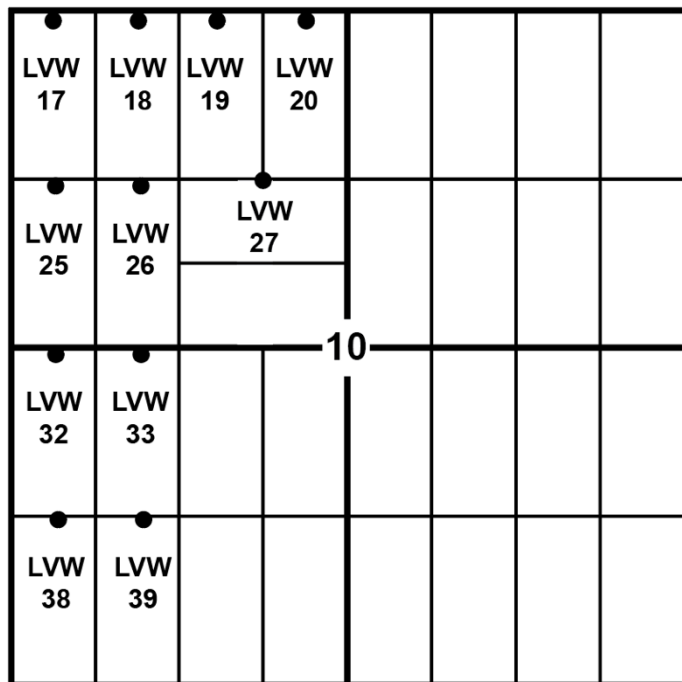

8. Locators of this Placer Claim:

Charles Watson
Advanced Geologic Exploration, Inc.
PO Box 1956
Chester, CA 96020

9. Signed by Charles P. Watson, Advanced Geologic _____.

RECORDING REQUESTED BY:
(Mail Recording to:)

Charles Watson
Advanced Geologic Exploration, Inc.
PO Box 1956
Chester, CA 96020

Placer Mining Claim Certificate of Location

1. The name of this Placer Mining Claim is: **LVW 28**
2. The date of this location as posted on said claim is: _____
3. The discovery monument is described as a wooden post painted red and secured in a mound of stone with an attached plastic bottle that contains the location notice.
4. The general course of the placer deposit is north to south.
5. The Placer Mining Claim is in **Esmeralda County**, Nevada and contains **±20 acres**.
6. The U.S. Public Land Survey and the legal subdivision including Aliquot Part Description is:

**W1/2 NW1/4 SE1/4 of Section, 9
Township 6S, Range 41E, M.D.M.**

7. Claim Location Map:

| | | | | | | | |
|--|--|--|--|---------------------|----------------|----------------|----------------|
| | | | | ● LVW 13 | ● LVW 14 | ● LVW 15 | ● LVW 16 |
| | | | | ● LVW 21 | ● LVW 22 | ● LVW 23 | ● LVW 24 |
| | | | | 9 ● LVW 28 | ● LVW 29 | ● LVW 30 | ● LVW 31 |
| | | | | ● LVW 34 | ● LVW 35 | ● LVW 36 | ● LVW 37 |

8. Locators of this Placer Claim:

Charles Watson
Advanced Geologic Exploration, Inc.
PO Box 1956
Chester, CA 96020

9. Signed by Charles P. Watson, Advanced Geologic _____.

RECORDING REQUESTED BY:
(Mail Recording to:)

Charles Watson
Advanced Geologic Exploration, Inc.
PO Box 1956
Chester, CA 96020

Placer Mining Claim Certificate of Location

1. The name of this Placer Mining Claim is: **LVW 29**
2. The date of this location as posted on said claim is: _____
3. The discovery monument is described as a wooden post painted red and secured in a mound of stone with an attached plastic bottle that contains the location notice.
4. The general course of the placer deposit is north to south.
5. The Placer Mining Claim is in **Esmeralda County**, Nevada and contains **±20 acres**.
6. The U.S. Public Land Survey and the legal subdivision including Aliquot Part Description is:

**E1/2 NW1/4 SE1/4 of Section, 9
Township 6S, Range 41E, M.D.M.**

7. Claim Location Map:

| | | | | | | | |
|--|--|--|--|----------------|----------------|----------------|----------------|
| | | | | ● LVW 13 | ● LVW 14 | ● LVW 15 | ● LVW 16 |
| | | | | ● LVW 21 | ● LVW 22 | ● LVW 23 | ● LVW 24 |
| | | | | ● LVW 28 | ● LVW 29 | ● LVW 30 | ● LVW 31 |
| | | | | ● LVW 34 | ● LVW 35 | ● LVW 36 | ● LVW 37 |

9

8. Locators of this Placer Claim:

Charles Watson
Advanced Geologic Exploration, Inc.
PO Box 1956
Chester, CA 96020

9. Signed by Charles P. Watson, Advanced Geologic _____.

RECORDING REQUESTED BY:
(Mail Recording to:)

Charles Watson
Advanced Geologic Exploration, Inc.
PO Box 1956
Chester, CA 96020

Placer Mining Claim Certificate of Location

1. The name of this Placer Mining Claim is: **LVW 30**
2. The date of this location as posted on said claim is: _____
3. The discovery monument is described as a wooden post painted red and secured in a mound of stone with an attached plastic bottle that contains the location notice.
4. The general course of the placer deposit is north to south.
5. The Placer Mining Claim is in **Esmeralda County**, Nevada and contains **±20 acres**.
6. The U.S. Public Land Survey and the legal subdivision including Aliquot Part Description is:

**W1/2 NE1/4 SE1/4 of Section, 9
Township 6S, Range 41E, M.D.M.**

7. Claim Location Map:

| | | | | | | | |
|--|--|--|--|----------------|----------------|----------------|----------------|
| | | | | ● LVW 13 | ● LVW 14 | ● LVW 15 | ● LVW 16 |
| | | | | ● LVW 21 | ● LVW 22 | ● LVW 23 | ● LVW 24 |
| | | | | ● LVW 28 | ● LVW 29 | ● LVW 30 | ● LVW 31 |
| | | | | ● LVW 34 | ● LVW 35 | ● LVW 36 | ● LVW 37 |

8. Locators of this Placer Claim:

Charles Watson
Advanced Geologic Exploration, Inc.
PO Box 1956
Chester, CA 96020

9. Signed by Charles P. Watson, Advanced Geologic _____.

RECORDING REQUESTED BY:
(Mail Recording to:)

Charles Watson
Advanced Geologic Exploration, Inc.
PO Box 1956
Chester, CA 96020

Placer Mining Claim Certificate of Location

1. The name of this Placer Mining Claim is: **LVW 31**
2. The date of this location as posted on said claim is: _____
3. The discovery monument is described as a wooden post painted red and secured in a mound of stone with an attached plastic bottle that contains the location notice.
4. The general course of the placer deposit is north to south.
5. The Placer Mining Claim is in **Esmeralda County**, Nevada and contains **±20 acres**.
6. The U.S. Public Land Survey and the legal subdivision including Aliquot Part Description is:

**E1/2 NE1/4 SE1/4 of Section, 9
Township 6S, Range 41E, M.D.M.**

7. Claim Location Map:

| | | | | | | | |
|--|--|--|--|----------------|----------------|----------------|----------------|
| | | | | ● LVW 13 | ● LVW 14 | ● LVW 15 | ● LVW 16 |
| | | | | ● LVW 21 | ● LVW 22 | ● LVW 23 | ● LVW 24 |
| | | | | ● LVW 28 | ● LVW 29 | ● LVW 30 | ● LVW 31 |
| | | | | ● LVW 34 | ● LVW 35 | ● LVW 36 | ● LVW 37 |

8. Locators of this Placer Claim:

Charles Watson
Advanced Geologic Exploration, Inc.
PO Box 1956
Chester, CA 96020

9. Signed by Charles P. Watson, Advanced Geologic _____.

RECORDING REQUESTED BY:
(Mail Recording to:)

Charles Watson
Advanced Geologic Exploration, Inc.
PO Box 1956
Chester, CA 96020

Placer Mining Claim Certificate of Location

1. The name of this Placer Mining Claim is: **LVW 32**
2. The date of this location as posted on said claim is: _____
3. The discovery monument is described as a wooden post painted red and secured in a mound of stone with an attached plastic bottle that contains the location notice.
4. The general course of the placer deposit is north to south.
5. The Placer Mining Claim is in **Esmeralda County**, Nevada and contains **±20 acres**.
6. The U.S. Public Land Survey and the legal subdivision including Aliquot Part Description is:

**W1/2 NW1/4 SW1/4 of Section, 10
Township 6S, Range 41E, M.D.M.**

7. Claim Location Map:

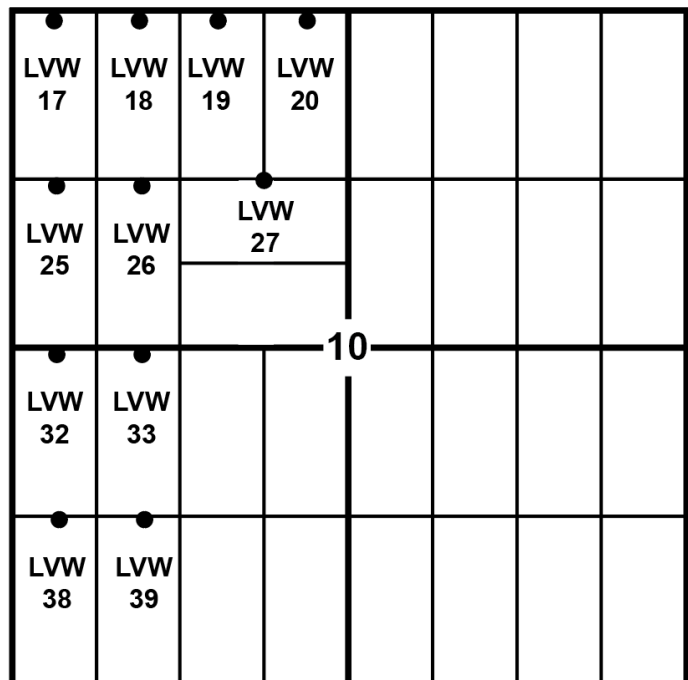

8. Locators of this Placer Claim:

Charles Watson
Advanced Geologic Exploration, Inc.
PO Box 1956
Chester, CA 96020

9. Signed by Charles P. Watson, Advanced Geologic _____.

RECORDING REQUESTED BY:
(Mail Recording to:)

Charles Watson
Advanced Geologic Exploration, Inc.
PO Box 1956
Chester, CA 96020

Placer Mining Claim Certificate of Location

1. The name of this Placer Mining Claim is: **LVW 33**
2. The date of this location as posted on said claim is: _____
3. The discovery monument is described as a wooden post painted red and secured in a mound of stone with an attached plastic bottle that contains the location notice.
4. The general course of the placer deposit is north to south.
5. The Placer Mining Claim is in **Esmeralda County**, Nevada and contains **±20 acres**.
6. The U.S. Public Land Survey and the legal subdivision including Aliquot Part Description is:

**E1/2 NW1/4 SW1/4 of Section, 10
Township 6S, Range 41E, M.D.M.**

7. Claim Location Map:

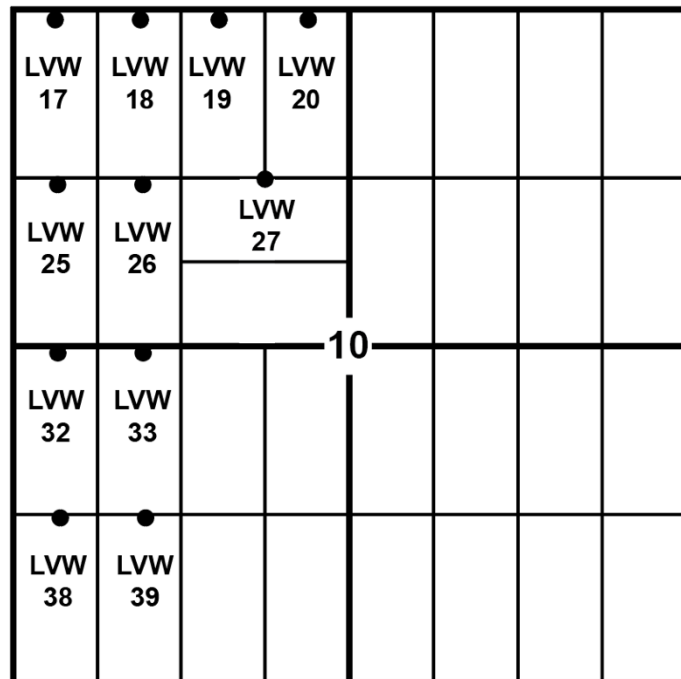

8. Locators of this Placer Claim:

Charles Watson
Advanced Geologic Exploration, Inc.
PO Box 1956
Chester, CA 96020

9. Signed by Charles P. Watson, Advanced Geologic _____.

RECORDING REQUESTED BY:
(Mail Recording to:)

Charles Watson
Advanced Geologic Exploration, Inc.
PO Box 1956
Chester, CA 96020

Placer Mining Claim Certificate of Location

1. The name of this Placer Mining Claim is: **LVW 34**
2. The date of this location as posted on said claim is: _____
3. The discovery monument is described as a wooden post painted red and secured in a mound of stone with an attached plastic bottle that contains the location notice.
4. The general course of the placer deposit is north to south.
5. The Placer Mining Claim is in **Esmeralda County**, Nevada and contains **±20 acres**.
6. The U.S. Public Land Survey and the legal subdivision including Aliquot Part Description is:

**W1/2 SW1/4 SE1/4 of Section, 9
Township 6S, Range 41E, M.D.M.**

7. Claim Location Map:

| | | | | | | | |
|--|--|--|---|----------------|----------------|----------------|----------------|
| | | | | ● LVW 13 | ● LVW 14 | ● LVW 15 | ● LVW 16 |
| | | | | ● LVW 21 | ● LVW 22 | ● LVW 23 | ● LVW 24 |
| | | | 9 | ● LVW 28 | ● LVW 29 | ● LVW 30 | ● LVW 31 |
| | | | | ● LVW 34 | ● LVW 35 | ● LVW 36 | ● LVW 37 |

8. Locators of this Placer Claim:

Charles Watson
Advanced Geologic Exploration, Inc.
PO Box 1956
Chester, CA 96020

9. Signed by Charles P. Watson, Advanced Geologic _____.

RECORDING REQUESTED BY:
(Mail Recording to:)

Charles Watson
Advanced Geologic Exploration, Inc.
PO Box 1956
Chester, CA 96020

Placer Mining Claim Certificate of Location

1. The name of this Placer Mining Claim is: **LVW 35**
2. The date of this location as posted on said claim is: _____
3. The discovery monument is described as a wooden post painted red and secured in a mound of stone with an attached plastic bottle that contains the location notice.
4. The general course of the placer deposit is north to south.
5. The Placer Mining Claim is in **Esmeralda County**, Nevada and contains **±20 acres**.
6. The U.S. Public Land Survey and the legal subdivision including Aliquot Part Description is:

**E1/2 SW1/4 SE1/4 of Section, 9
Township 6S, Range 41E, M.D.M.**

7. Claim Location Map:

| | | | | | | | |
|--|--|--|---|----------------|----------------|----------------|----------------|
| | | | | ● LVW 13 | ● LVW 14 | ● LVW 15 | ● LVW 16 |
| | | | | ● LVW 21 | ● LVW 22 | ● LVW 23 | ● LVW 24 |
| | | | 9 | ● LVW 28 | ● LVW 29 | ● LVW 30 | ● LVW 31 |
| | | | | ● LVW 34 | ● LVW 35 | ● LVW 36 | ● LVW 37 |

8. Locators of this Placer Claim:

Charles Watson
Advanced Geologic Exploration, Inc.
PO Box 1956
Chester, CA 96020

9. Signed by Charles P. Watson, Advanced Geologic _____.

RECORDING REQUESTED BY:
(Mail Recording to:)

Charles Watson
Advanced Geologic Exploration, Inc.
PO Box 1956
Chester, CA 96020

Placer Mining Claim Certificate of Location

1. The name of this Placer Mining Claim is: **LVW 36**
2. The date of this location as posted on said claim is: _____
3. The discovery monument is described as a wooden post painted red and secured in a mound of stone with an attached plastic bottle that contains the location notice.
4. The general course of the placer deposit is north to south.
5. The Placer Mining Claim is in **Esmeralda County**, Nevada and contains **±20 acres**.
6. The U.S. Public Land Survey and the legal subdivision including Aliquot Part Description is:

**W1/2 SE1/4 SE1/4 of Section, 9
Township 6S, Range 41E, M.D.M.**

7. Claim Location Map:

| | | | | | | | |
|--|--|--|--|----------------|----------------|----------------|----------------|
| | | | | ● LVW 13 | ● LVW 14 | ● LVW 15 | ● LVW 16 |
| | | | | ● LVW 21 | ● LVW 22 | ● LVW 23 | ● LVW 24 |
| | | | | ● LVW 28 | ● LVW 29 | ● LVW 30 | ● LVW 31 |
| | | | | ● LVW 34 | ● LVW 35 | ● LVW 36 | ● LVW 37 |

8. Locators of this Placer Claim:

Charles Watson
Advanced Geologic Exploration, Inc.
PO Box 1956
Chester, CA 96020

9. Signed by Charles P. Watson, Advanced Geologic _____.

RECORDING REQUESTED BY:
(Mail Recording to:)

Charles Watson
Advanced Geologic Exploration, Inc.
PO Box 1956
Chester, CA 96020

Placer Mining Claim Certificate of Location

1. The name of this Placer Mining Claim is: **LVW 37**
2. The date of this location as posted on said claim is: _____
3. The discovery monument is described as a wooden post painted red and secured in a mound of stone with an attached plastic bottle that contains the location notice.
4. The general course of the placer deposit is north to south.
5. The Placer Mining Claim is in **Esmeralda County**, Nevada and contains **±20 acres**.
6. The U.S. Public Land Survey and the legal subdivision including Aliquot Part Description is:

**E1/2 SE1/4 SE1/4 of Section, 9
Township 6S, Range 41E, M.D.M.**

7. Claim Location Map:

| | | | | | | | |
|--|--|--|--|----------------|----------------|----------------|----------------|
| | | | | ● LVW 13 | ● LVW 14 | ● LVW 15 | ● LVW 16 |
| | | | | ● LVW 21 | ● LVW 22 | ● LVW 23 | ● LVW 24 |
| | | | | ● LVW 28 | ● LVW 29 | ● LVW 30 | ● LVW 31 |
| | | | | ● LVW 34 | ● LVW 35 | ● LVW 36 | ● LVW 37 |

9

8. Locators of this Placer Claim:

Charles Watson
Advanced Geologic Exploration, Inc.
PO Box 1956
Chester, CA 96020

9. Signed by Charles P. Watson, Advanced Geologic _____.

RECORDING REQUESTED BY:
(Mail Recording to:)

Charles Watson
Advanced Geologic Exploration, Inc.
PO Box 1956
Chester, CA 96020

Placer Mining Claim Certificate of Location

1. The name of this Placer Mining Claim is: **LVW 38**
2. The date of this location as posted on said claim is: _____
3. The discovery monument is described as a wooden post painted red and secured in a mound of stone with an attached plastic bottle that contains the location notice.
4. The general course of the placer deposit is north to south.
5. The Placer Mining Claim is in **Esmeralda County**, Nevada and contains **±20 acres**.
6. The U.S. Public Land Survey and the legal subdivision including Aliquot Part Description is:

**W1/2 SW1/4 SW1/4 of Section, 10
Township 6S, Range 41E, M.D.M.**

7. Claim Location Map:

| | | | | | | | |
|----------------|----------------|----------------|----------------|----|--|--|--|
| ● LVW 17 | ● LVW 18 | ● LVW 19 | ● LVW 20 | | | | |
| ● LVW 25 | ● LVW 26 | ● LVW 27 | | | | | |
| ● LVW 32 | ● LVW 33 | | | 10 | | | |
| ● LVW 38 | ● LVW 39 | | | | | | |

8. Locators of this Placer Claim:

Charles Watson
Advanced Geologic Exploration, Inc.
PO Box 1956
Chester, CA 96020

9. Signed by Charles P. Watson, Advanced Geologic _____.

RECORDING REQUESTED BY:
(Mail Recording to:)

Charles Watson
Advanced Geologic Exploration, Inc.
PO Box 1956
Chester, CA 96020

Placer Mining Claim Certificate of Location

1. The name of this Placer Mining Claim is: **LVW 39**
2. The date of this location as posted on said claim is: _____
3. The discovery monument is described as a wooden post painted red and secured in a mound of stone with an attached plastic bottle that contains the location notice.
4. The general course of the placer deposit is north to south.
5. The Placer Mining Claim is in **Esmeralda County**, Nevada and contains **±20 acres**.
6. The U.S. Public Land Survey and the legal subdivision including Aliquot Part Description is:

**E1/2 SW1/4 SW1/4 of Section, 10
Township 6S, Range 41E, M.D.M.**

7. Claim Location Map:

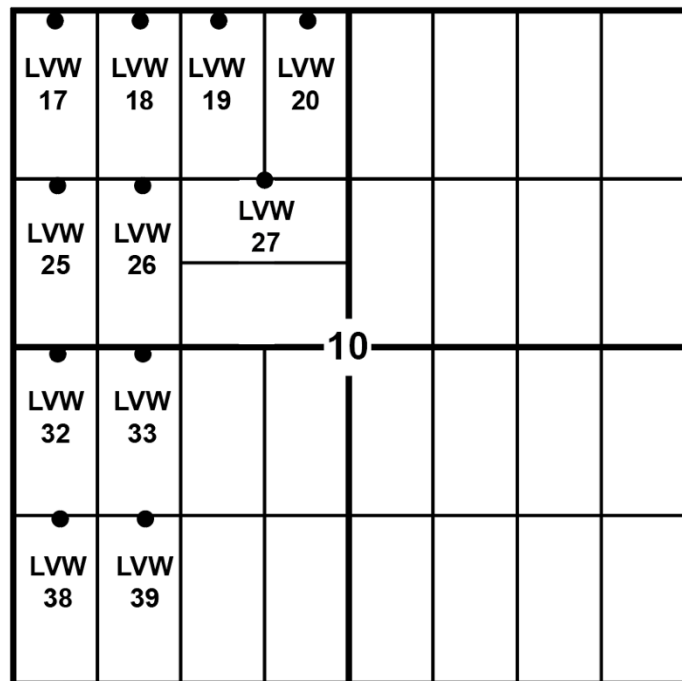

8. Locators of this Placer Claim:

Charles Watson
Advanced Geologic Exploration, Inc.
PO Box 1956
Chester, CA 96020

9. Signed by Charles P. Watson, Advanced Geologic _____.

RECORDING REQUESTED BY:
(Mail Recording to:)

Charles Watson
Advanced Geologic Exploration, Inc.
PO Box 1956
Chester, CA 96020

Placer Mining Claim Certificate of Location

1. The name of this Placer Mining Claim is: **LVW 40**
2. The date of this location as posted on said claim is: _____
3. The discovery monument is described as a wooden post painted red and secured in a mound of stone with an attached plastic bottle that contains the location notice.
4. The general course of the placer deposit is north to south.
5. The Placer Mining Claim is in **Esmeralda County**, Nevada and contains **±20 acres**.
6. The U.S. Public Land Survey and the legal subdivision including Aliquot Part Description is:

**W1/2 NW1/4 NE1/4 of Section, 15
Township 6S, Range 41E, M.D.M.**

7. Claim Location Map:

| | | | | | | | |
|--|--|--|--|----------------|----------------|----------------|----------------|
| | | | | ● LVW 40 | ● LVW 41 | ● LVW 42 | ● LVW 43 |
| | | | | ● LVW 46 | ● LVW 47 | ● LVW 48 | ● LVW 49 |
| | | | | ● LVW 52 | ● LVW 53 | ● LVW 54 | ● LVW 55 |
| | | | | | | ● LVW 58 | ● LVW 59 |

16

8. Locators of this Placer Claim:

Charles Watson
Advanced Geologic Exploration, Inc.
PO Box 1956
Chester, CA 96020

9. Signed by Charles P. Watson, Advanced Geologic _____.

RECORDING REQUESTED BY:
(Mail Recording to:)

Charles Watson
Advanced Geologic Exploration, Inc.
PO Box 1956
Chester, CA 96020

Placer Mining Claim Certificate of Location

1. The name of this Placer Mining Claim is: **LVW 41**
2. The date of this location as posted on said claim is: _____
3. The discovery monument is described as a wooden post painted red and secured in a mound of stone with an attached plastic bottle that contains the location notice.
4. The general course of the placer deposit is north to south.
5. The Placer Mining Claim is in **Esmeralda County**, Nevada and contains **±20 acres**.
6. The U.S. Public Land Survey and the legal subdivision including Aliquot Part Description is:

**E1/2 NW1/4 NE1/4 of Section, 15
Township 6S, Range 41E, M.D.M.**

7. Claim Location Map:

| | | | | | | | |
|--|--|--|----|----------------|----------------|----------------|----------------|
| | | | | ● LVW 40 | ● LVW 41 | ● LVW 42 | ● LVW 43 |
| | | | | ● LVW 46 | ● LVW 47 | ● LVW 48 | ● LVW 49 |
| | | | 16 | ● LVW 52 | ● LVW 53 | ● LVW 54 | ● LVW 55 |
| | | | | | | ● LVW 58 | ● LVW 59 |

8. Locators of this Placer Claim:

Charles Watson
Advanced Geologic Exploration, Inc.
PO Box 1956
Chester, CA 96020

9. Signed by Charles P. Watson, Advanced Geologic _____.

RECORDING REQUESTED BY:
(Mail Recording to:)

Charles Watson
Advanced Geologic Exploration, Inc.
PO Box 1956
Chester, CA 96020

Placer Mining Claim Certificate of Location

1. The name of this Placer Mining Claim is: **LVW 42**
2. The date of this location as posted on said claim is: _____
3. The discovery monument is described as a wooden post painted red and secured in a mound of stone with an attached plastic bottle that contains the location notice.
4. The general course of the placer deposit is north to south.
5. The Placer Mining Claim is in **Esmeralda County**, Nevada and contains **±20 acres**.
6. The U.S. Public Land Survey and the legal subdivision including Aliquot Part Description is:

**W1/2 NE1/4 NE1/4 of Section, 15
Township 6S, Range 41E, M.D.M.**

7. Claim Location Map:

| | | | | | | | |
|--|--|--|--|----------------|----------------|----------------|----------------|
| | | | | ● LVW 40 | ● LVW 41 | ● LVW 42 | ● LVW 43 |
| | | | | ● LVW 46 | ● LVW 47 | ● LVW 48 | ● LVW 49 |
| | | | | ● LVW 52 | ● LVW 53 | ● LVW 54 | ● LVW 55 |
| | | | | | | ● LVW 58 | ● LVW 59 |

16

8. Locators of this Placer Claim:

Charles Watson
Advanced Geologic Exploration, Inc.
PO Box 1956
Chester, CA 96020

9. Signed by Charles P. Watson, Advanced Geologic _____.

RECORDING REQUESTED BY:
(Mail Recording to:)

Charles Watson
Advanced Geologic Exploration, Inc.
PO Box 1956
Chester, CA 96020

Placer Mining Claim Certificate of Location

1. The name of this Placer Mining Claim is: **LVW 43**
2. The date of this location as posted on said claim is: _____
3. The discovery monument is described as a wooden post painted red and secured in a mound of stone with an attached plastic bottle that contains the location notice.
4. The general course of the placer deposit is north to south.
5. The Placer Mining Claim is in **Esmeralda County**, Nevada and contains **±20 acres**.
6. The U.S. Public Land Survey and the legal subdivision including Aliquot Part Description is:

**E1/2 NE1/4 NE1/4 of Section, 15
Township 6S, Range 41E, M.D.M.**

7. Claim Location Map:

| | | | | | | | |
|--|--|--|--|----------------|----------------|----------------|----------------|
| | | | | ● LVW 40 | ● LVW 41 | ● LVW 42 | ● LVW 43 |
| | | | | ● LVW 46 | ● LVW 47 | ● LVW 48 | ● LVW 49 |
| | | | | ● LVW 52 | ● LVW 53 | ● LVW 54 | ● LVW 55 |
| | | | | | | ● LVW 58 | ● LVW 59 |

16

8. Locators of this Placer Claim:

Charles Watson
Advanced Geologic Exploration, Inc.
PO Box 1956
Chester, CA 96020

9. Signed by Charles P. Watson, Advanced Geologic _____.

RECORDING REQUESTED BY:
(Mail Recording to:)

Charles Watson
Advanced Geologic Exploration, Inc.
PO Box 1956
Chester, CA 96020

Placer Mining Claim Certificate of Location

1. The name of this Placer Mining Claim is: **LVW 44**
2. The date of this location as posted on said claim is: _____
3. The discovery monument is described as a wooden post painted red and secured in a mound of stone with an attached plastic bottle that contains the location notice.
4. The general course of the placer deposit is north to south.
5. The Placer Mining Claim is in **Esmeralda County**, Nevada and contains **±20 acres**.
6. The U.S. Public Land Survey and the legal subdivision including Aliquot Part Description is:

**W1/2 NW1/4 NW1/4 of Section, 15
Township 6S, Range 41E, M.D.M.**

7. Claim Location Map:

| | | | | | | | |
|----------------|----------------|----------------|--|--|--|--|--|
| ● LVW 44 | ● LVW 45 | | | | | | |
| ● LVW 50 | ● LVW 51 | | | | | | |
| ● LVW 56 | ● LVW 57 | | | | | | |
| ● LVW 60 | ● LVW 61 | ● LVW 62 | | | | | |

8. Locators of this Placer Claim:

Charles Watson
Advanced Geologic Exploration, Inc.
PO Box 1956
Chester, CA 96020

9. Signed by Charles P. Watson, Advanced Geologic _____.

RECORDING REQUESTED BY:
(Mail Recording to:)

Charles Watson
Advanced Geologic Exploration, Inc.
PO Box 1956
Chester, CA 96020

Placer Mining Claim Certificate of Location

1. The name of this Placer Mining Claim is: **LVW 45**
2. The date of this location as posted on said claim is: _____
3. The discovery monument is described as a wooden post painted red and secured in a mound of stone with an attached plastic bottle that contains the location notice.
4. The general course of the placer deposit is north to south.
5. The Placer Mining Claim is in **Esmeralda County**, Nevada and contains **±20 acres**.
6. The U.S. Public Land Survey and the legal subdivision including Aliquot Part Description is:

**E1/2 NW1/4 NW1/4 of Section, 15
Township 6S, Range 41E, M.D.M.**

7. Claim Location Map:

| | | | | | | | |
|----------------|----------------|----------------|--|----|--|--|--|
| ● LVW 44 | ● LVW 45 | | | | | | |
| ● LVW 50 | ● LVW 51 | | | | | | |
| ● LVW 56 | ● LVW 57 | | | 15 | | | |
| ● LVW 60 | ● LVW 61 | ● LVW 62 | | | | | |

8. Locators of this Placer Claim:

Charles Watson
Advanced Geologic Exploration, Inc.
PO Box 1956
Chester, CA 96020

9. Signed by Charles P. Watson, Advanced Geologic _____.

RECORDING REQUESTED BY:
(Mail Recording to:)

Charles Watson
Advanced Geologic Exploration, Inc.
PO Box 1956
Chester, CA 96020

Placer Mining Claim Certificate of Location

1. The name of this Placer Mining Claim is: **LVW 46**
2. The date of this location as posted on said claim is: _____
3. The discovery monument is described as a wooden post painted red and secured in a mound of stone with an attached plastic bottle that contains the location notice.
4. The general course of the placer deposit is north to south.
5. The Placer Mining Claim is in **Esmeralda County**, Nevada and contains **±20 acres**.
6. The U.S. Public Land Survey and the legal subdivision including Aliquot Part Description is:

**W1/2 SW1/4 NE1/4 of Section, 15
Township 6S, Range 41E, M.D.M.**

7. Claim Location Map:

| | | | | | | | |
|--|--|--|----|----------------|----------------|----------------|----------------|
| | | | | ● LVW 40 | ● LVW 41 | ● LVW 42 | ● LVW 43 |
| | | | | ● LVW 46 | ● LVW 47 | ● LVW 48 | ● LVW 49 |
| | | | 16 | ● LVW 52 | ● LVW 53 | ● LVW 54 | ● LVW 55 |
| | | | | | | ● LVW 58 | ● LVW 59 |

8. Locators of this Placer Claim:

Charles Watson
Advanced Geologic Exploration, Inc.
PO Box 1956
Chester, CA 96020

9. Signed by Charles P. Watson, Advanced Geologic _____.

RECORDING REQUESTED BY:
(Mail Recording to:)

Charles Watson
Advanced Geologic Exploration, Inc.
PO Box 1956
Chester, CA 96020

Placer Mining Claim Certificate of Location

1. The name of this Placer Mining Claim is: **LVW 47**
2. The date of this location as posted on said claim is: _____
3. The discovery monument is described as a wooden post painted red and secured in a mound of stone with an attached plastic bottle that contains the location notice.
4. The general course of the placer deposit is north to south.
5. The Placer Mining Claim is in **Esmeralda County**, Nevada and contains **±20 acres**.
6. The U.S. Public Land Survey and the legal subdivision including Aliquot Part Description is:

**E1/2 SW1/4 NE1/4 of Section, 15
Township 6S, Range 41E, M.D.M.**

7. Claim Location Map:

| | | | | | | | |
|--|--|--|----|----------------|----------------|----------------|----------------|
| | | | | ● LVW 40 | ● LVW 41 | ● LVW 42 | ● LVW 43 |
| | | | | ● LVW 46 | ● LVW 47 | ● LVW 48 | ● LVW 49 |
| | | | 16 | ● LVW 52 | ● LVW 53 | ● LVW 54 | ● LVW 55 |
| | | | | | | ● LVW 58 | ● LVW 59 |

8. Locators of this Placer Claim:

Charles Watson
Advanced Geologic Exploration, Inc.
PO Box 1956
Chester, CA 96020

9. Signed by Charles P. Watson, Advanced Geologic _____.

RECORDING REQUESTED BY:
(Mail Recording to:)

Charles Watson
Advanced Geologic Exploration, Inc.
PO Box 1956
Chester, CA 96020

Placer Mining Claim Certificate of Location

1. The name of this Placer Mining Claim is: **LVW 48**
2. The date of this location as posted on said claim is: _____
3. The discovery monument is described as a wooden post painted red and secured in a mound of stone with an attached plastic bottle that contains the location notice.
4. The general course of the placer deposit is north to south.
5. The Placer Mining Claim is in **Esmeralda County**, Nevada and contains **±20 acres**.
6. The U.S. Public Land Survey and the legal subdivision including Aliquot Part Description is:

**W1/2 SE1/4 NE1/4 of Section, 15
Township 6S, Range 41E, M.D.M.**

7. Claim Location Map:

| | | | | | | | |
|--|--|--|--|----------------|----------------|----------------|----------------|
| | | | | ● LVW 40 | ● LVW 41 | ● LVW 42 | ● LVW 43 |
| | | | | ● LVW 46 | ● LVW 47 | ● LVW 48 | ● LVW 49 |
| | | | | ● LVW 52 | ● LVW 53 | ● LVW 54 | ● LVW 55 |
| | | | | | | ● LVW 58 | ● LVW 59 |

16

8. Locators of this Placer Claim:

Charles Watson
Advanced Geologic Exploration, Inc.
PO Box 1956
Chester, CA 96020

9. Signed by Charles P. Watson, Advanced Geologic _____.

RECORDING REQUESTED BY:
(Mail Recording to:)

Charles Watson
Advanced Geologic Exploration, Inc.
PO Box 1956
Chester, CA 96020

Placer Mining Claim Certificate of Location

1. The name of this Placer Mining Claim is: **LVW 49**
2. The date of this location as posted on said claim is: _____
3. The discovery monument is described as a wooden post painted red and secured in a mound of stone with an attached plastic bottle that contains the location notice.
4. The general course of the placer deposit is north to south.
5. The Placer Mining Claim is in **Esmeralda County**, Nevada and contains **±20 acres**.
6. The U.S. Public Land Survey and the legal subdivision including Aliquot Part Description is:

**E1/2 SE1/4 NE1/4 of Section, 15
Township 6S, Range 41E, M.D.M.**

7. Claim Location Map:

| | | | | | | | |
|--|--|--|--|----------------|----------------|----------------|----------------|
| | | | | ● LVW 40 | ● LVW 41 | ● LVW 42 | ● LVW 43 |
| | | | | ● LVW 46 | ● LVW 47 | ● LVW 48 | ● LVW 49 |
| | | | | ● LVW 52 | ● LVW 53 | ● LVW 54 | ● LVW 55 |
| | | | | | | ● LVW 58 | ● LVW 59 |

16

8. Locators of this Placer Claim:

Charles Watson
Advanced Geologic Exploration, Inc.
PO Box 1956
Chester, CA 96020

9. Signed by Charles P. Watson, Advanced Geologic _____.

RECORDING REQUESTED BY:
(Mail Recording to:)

Charles Watson
Advanced Geologic Exploration, Inc.
PO Box 1956
Chester, CA 96020

Placer Mining Claim Certificate of Location

1. The name of this Placer Mining Claim is: **LVW 50**
2. The date of this location as posted on said claim is: _____
3. The discovery monument is described as a wooden post painted red and secured in a mound of stone with an attached plastic bottle that contains the location notice.
4. The general course of the placer deposit is north to south.
5. The Placer Mining Claim is in **Esmeralda County**, Nevada and contains **±20 acres**.
6. The U.S. Public Land Survey and the legal subdivision including Aliquot Part Description is:

**W1/2 SW1/4 NW1/4 of Section, 15
Township 6S, Range 41E, M.D.M.**

7. Claim Location Map:

| | | | | | | | |
|----------------|----------------|----------------|--|----|--|--|--|
| ● LVW 44 | ● LVW 45 | | | | | | |
| ● LVW 50 | ● LVW 51 | | | | | | |
| ● LVW 56 | ● LVW 57 | | | 15 | | | |
| ● LVW 60 | ● LVW 61 | ● LVW 62 | | | | | |

8. Locators of this Placer Claim:

Charles Watson
Advanced Geologic Exploration, Inc.
PO Box 1956
Chester, CA 96020

9. Signed by Charles P. Watson, Advanced Geologic _____.

RECORDING REQUESTED BY:
(Mail Recording to:)

Charles Watson
Advanced Geologic Exploration, Inc.
PO Box 1956
Chester, CA 96020

Placer Mining Claim Certificate of Location

1. The name of this Placer Mining Claim is: **LVW 51**
2. The date of this location as posted on said claim is: _____
3. The discovery monument is described as a wooden post painted red and secured in a mound of stone with an attached plastic bottle that contains the location notice.
4. The general course of the placer deposit is north to south.
5. The Placer Mining Claim is in **Esmeralda County**, Nevada and contains **±20 acres**.
6. The U.S. Public Land Survey and the legal subdivision including Aliquot Part Description is:

**E1/2 SW1/4 NW1/4 of Section, 15
Township 6S, Range 41E, M.D.M.**

7. Claim Location Map:

| | | | | | | | |
|----------------|----------------|----------------|--|--|--|--|--|
| ● LVW 44 | ● LVW 45 | | | | | | |
| ● LVW 50 | ● LVW 51 | | | | | | |
| ● LVW 56 | ● LVW 57 | | | | | | |
| ● LVW 60 | ● LVW 61 | ● LVW 62 | | | | | |

8. Locators of this Placer Claim:

Charles Watson
Advanced Geologic Exploration, Inc.
PO Box 1956
Chester, CA 96020

9. Signed by Charles P. Watson, Advanced Geologic _____.

RECORDING REQUESTED BY:
(Mail Recording to:)

Charles Watson
Advanced Geologic Exploration, Inc.
PO Box 1956
Chester, CA 96020

Placer Mining Claim Certificate of Location

1. The name of this Placer Mining Claim is: **LVW 52**
2. The date of this location as posted on said claim is: _____
3. The discovery monument is described as a wooden post painted red and secured in a mound of stone with an attached plastic bottle that contains the location notice.
4. The general course of the placer deposit is north to south.
5. The Placer Mining Claim is in **Esmeralda County**, Nevada and contains **±20 acres**.
6. The U.S. Public Land Survey and the legal subdivision including Aliquot Part Description is:

**W1/2 NW1/4 SE1/4 of Section, 15
Township 6S, Range 41E, M.D.M.**

7. Claim Location Map:

| | | | | | | | |
|--|--|--|-----------|----------------|----------------|----------------|----------------|
| | | | | ● LVW 40 | ● LVW 41 | ● LVW 42 | ● LVW 43 |
| | | | | ● LVW 46 | ● LVW 47 | ● LVW 48 | ● LVW 49 |
| | | | 16 | ● LVW 52 | ● LVW 53 | ● LVW 54 | ● LVW 55 |
| | | | | | | ● LVW 58 | ● LVW 59 |

8. Locators of this Placer Claim:

Charles Watson
Advanced Geologic Exploration, Inc.
PO Box 1956
Chester, CA 96020

9. Signed by Charles P. Watson, Advanced Geologic _____.

RECORDING REQUESTED BY:
(Mail Recording to:)

Charles Watson
Advanced Geologic Exploration, Inc.
PO Box 1956
Chester, CA 96020

Placer Mining Claim Certificate of Location

1. The name of this Placer Mining Claim is: **LVW 53**
2. The date of this location as posted on said claim is: _____
3. The discovery monument is described as a wooden post painted red and secured in a mound of stone with an attached plastic bottle that contains the location notice.
4. The general course of the placer deposit is north to south.
5. The Placer Mining Claim is in **Esmeralda County**, Nevada and contains **±20 acres**.
6. The U.S. Public Land Survey and the legal subdivision including Aliquot Part Description is:

**E1/2 NW1/4 SE1/4 of Section, 15
Township 6S, Range 41E, M.D.M.**

7. Claim Location Map:

| | | | | | | | |
|--|--|--|----|----------------|----------------|----------------|----------------|
| | | | | ● LVW 40 | ● LVW 41 | ● LVW 42 | ● LVW 43 |
| | | | | ● LVW 46 | ● LVW 47 | ● LVW 48 | ● LVW 49 |
| | | | 16 | ● LVW 52 | ● LVW 53 | ● LVW 54 | ● LVW 55 |
| | | | | | | ● LVW 58 | ● LVW 59 |

8. Locators of this Placer Claim:

Charles Watson
Advanced Geologic Exploration, Inc.
PO Box 1956
Chester, CA 96020

9. Signed by Charles P. Watson, Advanced Geologic _____.

RECORDING REQUESTED BY:
(Mail Recording to:)

Charles Watson
Advanced Geologic Exploration, Inc.
PO Box 1956
Chester, CA 96020

Placer Mining Claim Certificate of Location

1. The name of this Placer Mining Claim is: **LVW 54**
2. The date of this location as posted on said claim is: _____
3. The discovery monument is described as a wooden post painted red and secured in a mound of stone with an attached plastic bottle that contains the location notice.
4. The general course of the placer deposit is north to south.
5. The Placer Mining Claim is in **Esmeralda County**, Nevada and contains **±20 acres**.
6. The U.S. Public Land Survey and the legal subdivision including Aliquot Part Description is:

**W1/2 NE1/4 SE1/4 of Section, 15
Township 6S, Range 41E, M.D.M.**

7. Claim Location Map:

| | | | | | | | |
|--|--|--|----|----------------|----------------|----------------|----------------|
| | | | | ● LVW 40 | ● LVW 41 | ● LVW 42 | ● LVW 43 |
| | | | | ● LVW 46 | ● LVW 47 | ● LVW 48 | ● LVW 49 |
| | | | 16 | ● LVW 52 | ● LVW 53 | ● LVW 54 | ● LVW 55 |
| | | | | | | ● LVW 58 | ● LVW 59 |

8. Locators of this Placer Claim:

Charles Watson
Advanced Geologic Exploration, Inc.
PO Box 1956
Chester, CA 96020

9. Signed by Charles P. Watson, Advanced Geologic _____.

RECORDING REQUESTED BY:
(Mail Recording to:)

Charles Watson
Advanced Geologic Exploration, Inc.
PO Box 1956
Chester, CA 96020

Placer Mining Claim Certificate of Location

1. The name of this Placer Mining Claim is: **LVW 55**
2. The date of this location as posted on said claim is: _____
3. The discovery monument is described as a wooden post painted red and secured in a mound of stone with an attached plastic bottle that contains the location notice.
4. The general course of the placer deposit is north to south.
5. The Placer Mining Claim is in **Esmeralda County**, Nevada and contains **±20 acres**.
6. The U.S. Public Land Survey and the legal subdivision including Aliquot Part Description is:

**E1/2 NE1/4 SE1/4 of Section, 15
Township 6S, Range 41E, M.D.M.**

7. Claim Location Map:

| | | | | | | | |
|--|--|--|-----------|----------------|----------------|----------------|----------------|
| | | | | ● LVW 40 | ● LVW 41 | ● LVW 42 | ● LVW 43 |
| | | | | ● LVW 46 | ● LVW 47 | ● LVW 48 | ● LVW 49 |
| | | | 16 | ● LVW 52 | ● LVW 53 | ● LVW 54 | ● LVW 55 |
| | | | | | | ● LVW 58 | ● LVW 59 |

8. Locators of this Placer Claim:

Charles Watson
Advanced Geologic Exploration, Inc.
PO Box 1956
Chester, CA 96020

9. Signed by Charles P. Watson, Advanced Geologic _____.

RECORDING REQUESTED BY:
(Mail Recording to:)

Charles Watson
Advanced Geologic Exploration, Inc.
PO Box 1956
Chester, CA 96020

Placer Mining Claim Certificate of Location

1. The name of this Placer Mining Claim is: **LVW 56**
2. The date of this location as posted on said claim is: _____
3. The discovery monument is described as a wooden post painted red and secured in a mound of stone with an attached plastic bottle that contains the location notice.
4. The general course of the placer deposit is north to south.
5. The Placer Mining Claim is in **Esmeralda County**, Nevada and contains **±20 acres**.
6. The U.S. Public Land Survey and the legal subdivision including Aliquot Part Description is:

**W1/2 NW1/4 SW1/4 of Section, 15
Township 6S, Range 41E, M.D.M.**

7. Claim Location Map:

| | | | | | | | |
|----------------|----------------|----------------|----|--|--|--|--|
| ● LVW 44 | ● LVW 45 | | | | | | |
| ● LVW 50 | ● LVW 51 | | | | | | |
| ● LVW 56 | ● LVW 57 | | 15 | | | | |
| ● LVW 60 | ● LVW 61 | ● LVW 62 | | | | | |

8. Locators of this Placer Claim:

Charles Watson
Advanced Geologic Exploration, Inc.
PO Box 1956
Chester, CA 96020

9. Signed by Charles P. Watson, Advanced Geologic _____.

RECORDING REQUESTED BY:
(Mail Recording to:)

Charles Watson
Advanced Geologic Exploration, Inc.
PO Box 1956
Chester, CA 96020

Placer Mining Claim Certificate of Location

1. The name of this Placer Mining Claim is: **LVW 57**
2. The date of this location as posted on said claim is: _____
3. The discovery monument is described as a wooden post painted red and secured in a mound of stone with an attached plastic bottle that contains the location notice.
4. The general course of the placer deposit is north to south.
5. The Placer Mining Claim is in **Esmeralda County**, Nevada and contains **±20 acres**.
6. The U.S. Public Land Survey and the legal subdivision including Aliquot Part Description is:

**E1/2 NW1/4 SW1/4 of Section, 15
Township 6S, Range 41E, M.D.M.**

7. Claim Location Map:

| | | | | | | | |
|----------------|----------------|----------------|----|--|--|--|--|
| ● LVW 44 | ● LVW 45 | | | | | | |
| ● LVW 50 | ● LVW 51 | | | | | | |
| ● LVW 56 | ● LVW 57 | | 15 | | | | |
| ● LVW 60 | ● LVW 61 | ● LVW 62 | | | | | |

8. Locators of this Placer Claim:

Charles Watson
Advanced Geologic Exploration, Inc.
PO Box 1956
Chester, CA 96020

9. Signed by Charles P. Watson, Advanced Geologic _____.

RECORDING REQUESTED BY:
(Mail Recording to:)

Charles Watson
Advanced Geologic Exploration, Inc.
PO Box 1956
Chester, CA 96020

Placer Mining Claim Certificate of Location

1. The name of this Placer Mining Claim is: **LVW 58**
2. The date of this location as posted on said claim is: _____
3. The discovery monument is described as a wooden post painted red and secured in a mound of stone with an attached plastic bottle that contains the location notice.
4. The general course of the placer deposit is north to south.
5. The Placer Mining Claim is in **Esmeralda County**, Nevada and contains **±20 acres**.
6. The U.S. Public Land Survey and the legal subdivision including Aliquot Part Description is:

**W1/2 SE1/4 SE1/4 of Section, 15
Township 6S, Range 41E, M.D.M.**

7. Claim Location Map:

| | | | | | | | |
|--|--|--|--|----------------|----------------|----------------|----------------|
| | | | | ● LVW 40 | ● LVW 41 | ● LVW 42 | ● LVW 43 |
| | | | | ● LVW 46 | ● LVW 47 | ● LVW 48 | ● LVW 49 |
| | | | | ● LVW 52 | ● LVW 53 | ● LVW 54 | ● LVW 55 |
| | | | | | | ● LVW 58 | ● LVW 59 |

16

8. Locators of this Placer Claim:

Charles Watson
Advanced Geologic Exploration, Inc.
PO Box 1956
Chester, CA 96020

9. Signed by Charles P. Watson, Advanced Geologic _____.

RECORDING REQUESTED BY:
(Mail Recording to:)

Charles Watson
Advanced Geologic Exploration, Inc.
PO Box 1956
Chester, CA 96020

Placer Mining Claim Certificate of Location

1. The name of this Placer Mining Claim is: **LVW 59**
2. The date of this location as posted on said claim is: _____
3. The discovery monument is described as a wooden post painted red and secured in a mound of stone with an attached plastic bottle that contains the location notice.
4. The general course of the placer deposit is north to south.
5. The Placer Mining Claim is in **Esmeralda County**, Nevada and contains **±20 acres**.
6. The U.S. Public Land Survey and the legal subdivision including Aliquot Part Description is:

**E1/2 SE1/4 SE1/4 of Section, 15
Township 6S, Range 41E, M.D.M.**

7. Claim Location Map:

| | | | | | | | |
|--|--|--|----|----------------|----------------|----------------|----------------|
| | | | | ● LVW 40 | ● LVW 41 | ● LVW 42 | ● LVW 43 |
| | | | | ● LVW 46 | ● LVW 47 | ● LVW 48 | ● LVW 49 |
| | | | 16 | ● LVW 52 | ● LVW 53 | ● LVW 54 | ● LVW 55 |
| | | | | | | ● LVW 58 | ● LVW 59 |

8. Locators of this Placer Claim:

Charles Watson
Advanced Geologic Exploration, Inc.
PO Box 1956
Chester, CA 96020

9. Signed by Charles P. Watson, Advanced Geologic _____.

RECORDING REQUESTED BY:
(Mail Recording to:)

Charles Watson
Advanced Geologic Exploration, Inc.
PO Box 1956
Chester, CA 96020

Placer Mining Claim Certificate of Location

1. The name of this Placer Mining Claim is: **LVW 60**
2. The date of this location as posted on said claim is: _____
3. The discovery monument is described as a wooden post painted red and secured in a mound of stone with an attached plastic bottle that contains the location notice.
4. The general course of the placer deposit is north to south.
5. The Placer Mining Claim is in **Esmeralda County**, Nevada and contains **±20 acres**.
6. The U.S. Public Land Survey and the legal subdivision including Aliquot Part Description is:

**W1/2 SW1/4 SW1/4 of Section, 15
Township 6S, Range 41E, M.D.M.**

7. Claim Location Map:

| | | | | | | | |
|----------------|----------------|----------------|--|----|--|--|--|
| ● LVW 44 | ● LVW 45 | | | | | | |
| ● LVW 50 | ● LVW 51 | | | | | | |
| ● LVW 56 | ● LVW 57 | | | 15 | | | |
| ● LVW 60 | ● LVW 61 | ● LVW 62 | | | | | |

8. Locators of this Placer Claim:

Charles Watson
Advanced Geologic Exploration, Inc.
PO Box 1956
Chester, CA 96020

9. Signed by Charles P. Watson, Advanced Geologic _____.

RECORDING REQUESTED BY:
(Mail Recording to:)

Charles Watson
Advanced Geologic Exploration, Inc.
PO Box 1956
Chester, CA 96020

Placer Mining Claim Certificate of Location

1. The name of this Placer Mining Claim is: **LVW 61**
2. The date of this location as posted on said claim is: _____
3. The discovery monument is described as a wooden post painted red and secured in a mound of stone with an attached plastic bottle that contains the location notice.
4. The general course of the placer deposit is north to south.
5. The Placer Mining Claim is in **Esmeralda County**, Nevada and contains **±20 acres**.
6. The U.S. Public Land Survey and the legal subdivision including Aliquot Part Description is:

**E1/2 SW1/4 SW1/4 of Section, 15
Township 6S, Range 41E, M.D.M.**

7. Claim Location Map:

| | | | | | | | |
|----------------|----------------|----------------|--|----|--|--|--|
| ● LVW 44 | ● LVW 45 | | | | | | |
| ● LVW 50 | ● LVW 51 | | | | | | |
| ● LVW 56 | ● LVW 57 | | | 15 | | | |
| ● LVW 60 | ● LVW 61 | ● LVW 62 | | | | | |

8. Locators of this Placer Claim:

Charles Watson
Advanced Geologic Exploration, Inc.
PO Box 1956
Chester, CA 96020

9. Signed by Charles P. Watson, Advanced Geologic _____.

RECORDING REQUESTED BY:
(Mail Recording to:)

Charles Watson
Advanced Geologic Exploration, Inc.
PO Box 1956
Chester, CA 96020

Placer Mining Claim Certificate of Location

1. The name of this Placer Mining Claim is: **LVW 62**
2. The date of this location as posted on said claim is: _____
3. The discovery monument is described as a wooden post painted red and secured in a mound of stone with an attached plastic bottle that contains the location notice.
4. The general course of the placer deposit is north to south.
5. The Placer Mining Claim is in **Esmeralda County**, Nevada and contains **±20 acres**.
6. The U.S. Public Land Survey and the legal subdivision including Aliquot Part Description is:

**W1/2 SE1/4 SW1/4 of Section, 15
Township 6S, Range 41E, M.D.M.**

7. Claim Location Map:

| | | | | | | | |
|----------------|----------------|----------------|--|----|--|--|--|
| ● LVW 44 | ● LVW 45 | | | | | | |
| ● LVW 50 | ● LVW 51 | | | | | | |
| ● LVW 56 | ● LVW 57 | | | 15 | | | |
| ● LVW 60 | ● LVW 61 | ● LVW 62 | | | | | |

8. Locators of this Placer Claim:

Charles Watson
Advanced Geologic Exploration, Inc.
PO Box 1956
Chester, CA 96020

9. Signed by Charles P. Watson, Advanced Geologic _____.